



How to change brake
drum on **VW Polo
Classic (6V2)** –
replacement guide

SIMILAR VIDEO TUTORIAL



This video shows the replacement procedure of a similar car part on another vehicle

Important!

This replacement procedure can be used for:

VW Polo Classic (6V2) 1.6, VW Polo Classic (6V2) 1.4, VW Polo Classic (6V2) 1.9 SDI, VW Polo Classic (6V2) 1.9 TDI, VW Polo Classic (6V2) 1.8, VW Polo Classic (6V2) 1.7 SDI, VW Polo Classic (6V2) 1.9 D

The steps may slightly vary depending on the car design.

This tutorial was created based on the replacement procedure for a similar car part on: VW Polo Hatchback (6N1) 1.0

REPLACEMENT: BRAKE DRUM – VW POLO CLASSIC (6V2). LIST OF THE TOOLS YOU'LL NEED:



- Wire brush
- All-purpose cleaning spray
- Multipurpose grease
- Copper grease
- Torque wrench
- Combination spanner #10
- Drive socket # 24
- Wheel impact socket #17
- Ratchet wrench
- Hammer
- Crow bar
- Wheel chock

Buy tools

AUTODOC recommends:

- Replace the brake drums on VW Polo Classic (6V2) in pair for the rear axle. Disregarding the parts state. It ensures even braking.
- The replacement procedure is identical for the right and left brake drums on the same axle.
- When replacing the brake drums, be sure to also change the brake shoes.
- Please note: all work on the car – VW Polo Classic (6V2) – should be done with the engine switched off.

CARRY OUT REPLACEMENT IN THE FOLLOWING ORDER:

1

Engage the parking brake lever.

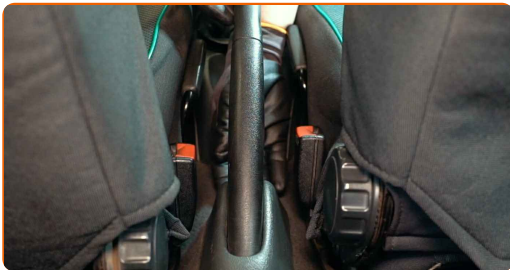

2

Loosen the parking brake cable. Use a combination spanner #10.

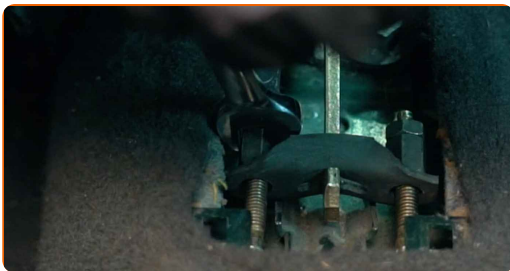

3

Secure the wheels with chocks.

4

Loosen the wheel mounting bolts. Use wheel impact socket #17.



5

Raise the rear of the car and secure on supports.

6

Unscrew the wheel bolts.



AUTODOC recommends:

- Important! Hold the wheel while unscrewing the fastening bolts. VW Polo Classic (6V2)

7

Remove the wheel.



8

Clean the brake drum. Use a wire brush. Use all-purpose cleaning spray.

**9**

Remove the wheel hub nut cap. Use a crowbar. Use a hammer.

**10**

Remove the cotter pin securing the hub nut. Use a crowbar. Use a hammer.

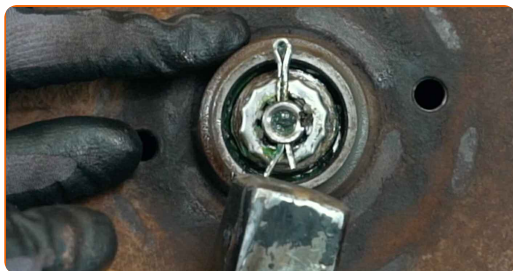
**11**

Unscrew the hub nut. Use a drive socket #24. Use a ratchet wrench.



12 Remove the brake drum assembled with the wheel hub bearing.



13 Clean the hub bearing mounting seat. Use all-purpose cleaning spray.



14 Treat the wheel hub in the area where it contacts the brake drum. Use a multipurpose grease.



15 Install the new brake drum assembled with the wheel hub bearing.



16 Install the wheel.



AUTODOC recommends:

- Important! Hold the wheel while screwing in the fastening bolts. VW Polo Classic (6V2)

17

Screw in the wheel bolts. Use wheel impact socket #17.



18

Screw on the hub nut. Use a drive socket #24. Use a ratchet wrench.



Replacement: brake drum – VW Polo Classic (6V2). Tip from AUTODOC experts:

- Align the brake drum.

19

Unscrew the wheel bolts. Use wheel impact socket #17.



AUTODOC recommends:

- Warning! To avoid injury, hold the wheel while unscrewing the fastening bolts. VW Polo Classic (6V2)

20

Remove the wheel.

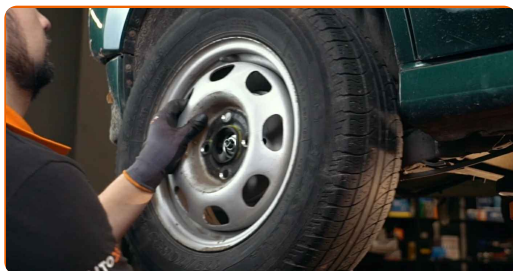

21

Install a new hub nut cotter pin. Use a crowbar. Use a hammer.

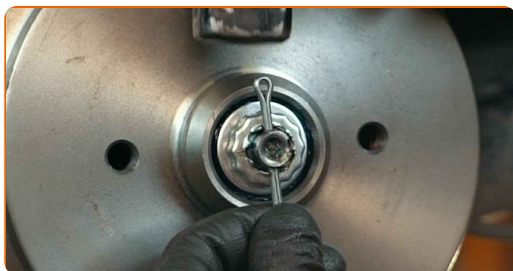

22

Install the cap of the hub nut. Use a hammer.



23

Treat the surface where the wheel rim contacts the brake drum. Use copper grease.



24 Install the wheel.



AUTODOC recommends:

- Warning! To avoid injury, hold the wheel while screwing in the fastening bolts on the car. VW Polo Classic (6V2)

25 Screw in the wheel bolts. Use wheel impact socket #17.



26 Adjust the parking brake cable tension. Use a combination spanner #10.



27 Release the parking brake lever.



- 28** Lower the car and working in a cross order, tighten the wheel bolts. Use wheel impact socket #17. Use a torque wrench. Tighten it to 110 Nm torque.



- 29** Remove the jacks and chocks.



WELL DONE! 

VIEW MORE TUTORIALS

AUTODOC – TOP QUALITY AND AFFORDABLE CAR PARTS ONLINE

AUTODOC MOBILE APP: GREAT DEALS AND CONVENIENT SHOPPING



+ AUTODOC

GET IT ON
 **Google Play**

Download on the
 **App Store**

Download

A GREAT SELECTION OF SPARE PARTS FOR YOUR CAR

BRAKE DRUM: A WIDE SELECTION

DISCLAIMER:

The document contains only general recommendations that may be useful for you when you perform repair or replacement work. AUTODOC shall not be liable for any loss, injury, damage of property occurring in the repair or replacement process due to incorrect use or misinterpretation of the provided information.

AUTODOC shall not be liable for any possible mistakes and uncertainties in this guide. The information provided is for information purposes only and cannot replace advice from specialists.

AUTODOC shall not be liable for incorrect or hazardous usage of equipment, tools and car parts. AUTODOC strongly recommends to be careful and observe the safety rules when performing repair or replacement works. Remember: usage of low quality auto parts does not guarantee you the appropriate level of road safety.

© Copyright 2023 – All the contents of this website, in particular texts, photographs and graphics, are protected by copyright. All rights, including reproduction, publication, editing and translation rights, are reserved by AUTODOC SE.