



How to change rear
brake pads on **VOLVO**
S80 II (124) –
replacement guide

SIMILAR VIDEO TUTORIAL



This video shows the replacement procedure of a similar car part on another vehicle

ⓘ Important!

This replacement procedure can be used for:

VOLVO S80 II (124) 1.6 T4, VOLVO S80 II (124) 2.0 T5, VOLVO S80 II (124) 3.0 T6 AWD, VOLVO S80 II (124) 2.0 D3 / D4, VOLVO S80 II (124) 3.2 AWD, VOLVO S80 II (124) 3.2, VOLVO S80 II (124) 1.6 DRIVe, VOLVO S80 II (124) 2.4 D5 AWD, VOLVO S80 II (124) 2.4 D5, VOLVO S80 II (124) 1.6 T4F, VOLVO S80 II (124) 4.4 V8 AWD, VOLVO S80 II (124) 2.5 T, VOLVO S80 II (124) 2.4 D, VOLVO S80 II (124) 2.5 T AWD, VOLVO S80 II (124) 2.5 T FlexFuel, (+ 9)

The steps may slightly vary depending on the car design.

This tutorial was created based on the replacement procedure for a similar car part on: VOLVO V70 III (135) 2.0 FlexiFuel

**REPLACEMENT: BRAKE PADS – VOLVO S80 II (124).
TOOLS YOU'LL NEED:**



- Wire brush
- Nylon cleaning brush
- WD-40 spray
- Brake cleaner
- Anti-squeal paste
- Ceramic grease
- Torque wrench
- Combination spanner #15
- Drive socket # 13
- Drive socket # 15
- Torx bit T50
- Wheel impact socket #19
- Ratchet wrench
- Tap wrench
- Brake caliper wind back tool
- Hammer
- Impact screwdriver
- Wheel chock

Buy tools

Replacement: brake pads – VOLVO S80 II (124). AUTODOC recommends:

- Perform the replacement of brake pads in complete set for each axis. This provides effective braking.
- The replacement procedure is identical for all brake pads on the same axle.
- Warning! Shut down the engine before starting any work – VOLVO S80 II (124).

CARRY OUT REPLACEMENT IN THE FOLLOWING ORDER:

1 Open the bonnet.

2 Unscrew the brake fluid reservoir cap.



3 Put the parking brake system into service mode.

4 Secure the wheels with chocks.

5 Loosen the wheel bolts. Use wheel impact socket #19. Use a tap wrench.



6 Raise the car.

Replacement: brake pads – VOLVO S80 II (124). Tip from AUTODOC experts:

- If you are using a jack, make sure it rests on a flat surface without any unevenness.
- Be sure to additionally secure the car with jack stands.

7 Unscrew the wheel bolts.



AUTODOC recommends:

- To avoid injury, hold up the wheel when unscrewing the bolts.

8 Remove the wheel.

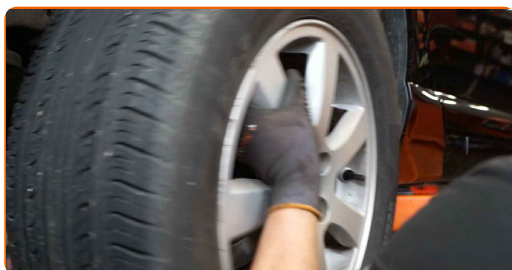

9

Clean the brake caliper fasteners. Use a wire brush. Use WD-40 spray.



10

Unscrew the brake caliper fasteners. Use a combination spanner #15. Use a drive socket #13. Use a ratchet wrench.



11

Remove the fastening bolts.



12

Remove the brake caliper.



Replacement: brake pads – VOLVO S80 II (124). Professionals recommend:

- Tie the caliper to the suspension or to the body with a wire without disconnecting from the brake hose to prevent depressurization of the brake system.
- Make sure that the brake caliper is not hanging on the brake hose.
- Don't press the brake pedal after the brake caliper has been removed. As a result, the piston can fall out from the brake cylinder, and brake fluid leakage and depressurization of the system may occur.

13

Remove the brake pads.



AUTODOC recommends:

- Measure the brake disc thickness. Upon reaching the wear limit the part must be replaced.

14

Clean the brake caliper bracket of dirt and dust. Use a wire brush. Use a brake cleaner.

Replacement: brake pads – VOLVO S80 II (124). Tip from AUTODOC:

- Check the brake caliper bracket, brake caliper guide pins and boots. Clean them. Replace, if necessary.

15

Treat the brake caliper piston. Use a nylon cleaning brush. Use a brake cleaner.

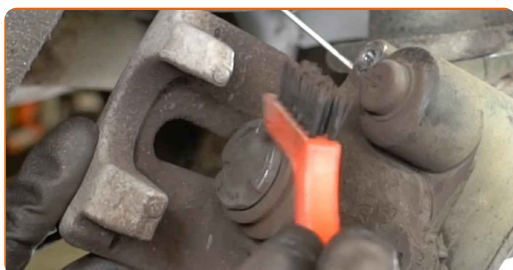

16

Press in the brake caliper piston. Use brake caliper wind back tool.

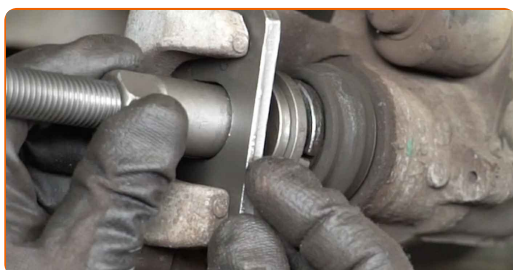

17

Treat the brake pads in the area where their surface comes into contact with the brake caliper bracket. Use anti-squeal paste.

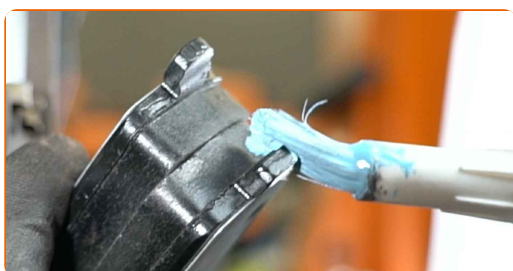

Replacement: brake pads – VOLVO S80 II (124). Tip:

- Make sure the disc surface is clean before installing the pads.

18 Install new brake pads.



19 Install the brake caliper and fasten it.

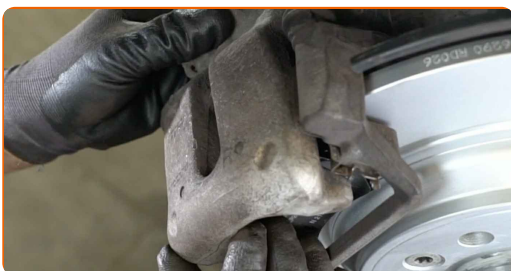

20 Install the fastening bolts.

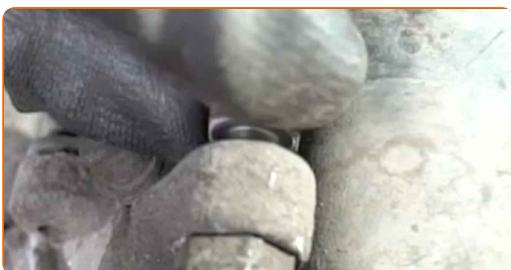

21 Tighten the brake caliper fasteners. Use a combination spanner #15. Use a drive socket #13. Use a torque wrench. Tighten it to 35 Nm torque.



22 Treat the surface where the brake disc contacts the wheel rim. Use ceramic grease.

23 Clean the brake disk surface. Use a brake cleaner.



24 Install the wheel.



AUTODOC recommends:

- Warning! To avoid injury, hold the wheel while screwing in the fastening bolts on the car. VOLVO S80 II (124)

25 Screw in the wheel bolts. Use wheel impact socket #19. Use a ratchet wrench.



- 26** Lower the car and working in a cross order, tighten the wheel bolts. Use wheel impact socket #19. Use a torque wrench. Tighten it to 140 Nm torque.



- 27** Remove the jacks and chocks.



AUTODOC recommends:

- Without starting the engine, press the brake pedal several times until you feel significant resistance.
- Check the brake fluid level in the expansion tank and top up if necessary.

- 28** Tighten the brake fluid reservoir cap.



29 Deactivate the service mode of the parking brake system.

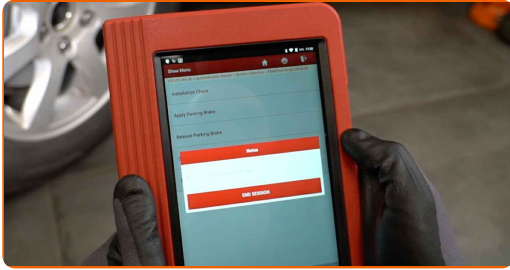

30 Close the bonnet.

Replacement: brake pads – VOLVO S80 II (124). Tip from AUTODOC experts:

- Slow down smoothly for first 150-200 km after the brake pads replacement. Avoid unnecessary and sharp braking to a stop.

WELL DONE! 

VIEW MORE TUTORIALS

AUTODOC – TOP QUALITY AND AFFORDABLE CAR PARTS ONLINE

AUTODOC MOBILE APP: GREAT DEALS AND CONVENIENT SHOPPING



+ AUTODOC

GET IT ON
Google Play

 Download on the
App Store

Download

A GREAT SELECTION OF SPARE PARTS FOR YOUR CAR

BRAKE PADS: A WIDE SELECTION

DISCLAIMER:

The document contains only general recommendations that may be useful for you when you perform repair or replacement work. AUTODOC shall not be liable for any loss, injury, damage of property occurring in the repair or replacement process due to incorrect use or misinterpretation of the provided information.

AUTODOC shall not be liable for any possible mistakes and uncertainties in this guide. The information provided is for information purposes only and cannot replace advice from specialists.

AUTODOC shall not be liable for incorrect or hazardous usage of equipment, tools and car parts. AUTODOC strongly recommends to be careful and observe the safety rules when performing repair or replacement works. Remember: usage of low quality auto parts does not guarantee you the appropriate level of road safety.

© Copyright 2023 – All the contents of this website, in particular texts, photographs and graphics, are protected by copyright. All rights, including reproduction, publication, editing and translation rights, are reserved by AUTODOC SE.