



How to change rear  
shock absorbers on  
**Hyundai Santa Fe CM** –  
replacement guide

## VIDEO TUTORIAL



### Important!

This replacement procedure can be used for:

HYUNDAI SANTA FÉ II (CM) 3.5 4x4, HYUNDAI SANTA FÉ II (CM) 2.0 CRDi, HYUNDAI SANTA FÉ II (CM) 2.4, HYUNDAI SANTA FÉ II (CM) 2.0 CRDi 4x4, HYUNDAI SANTA FÉ II (CM) 2.7 4x4, HYUNDAI SANTA FÉ II (CM) 2.7, HYUNDAI SANTA FÉ II (CM) 2.2 CRDi, HYUNDAI SANTA FÉ II (CM) 2.2 CRDi 4x4, HYUNDAI SANTA FÉ II (CM) 2.7 V6 GLS, HYUNDAI SANTA FÉ II (CM) 2.7 V6 GLS 4x4, HYUNDAI SANTA FÉ II (CM) 2.2 CRDi GLS, HYUNDAI SANTA FÉ II (CM) 2.2 CRDi GLS 4x4, HYUNDAI SANTA FÉ II (CM) 2.4 4x4

The steps may slightly vary depending on the car design.

REPLACEMENT: SHOCK ABSORBERS – HYUNDAI SANTA FE CM. LIST OF THE TOOLS YOU'LL NEED:

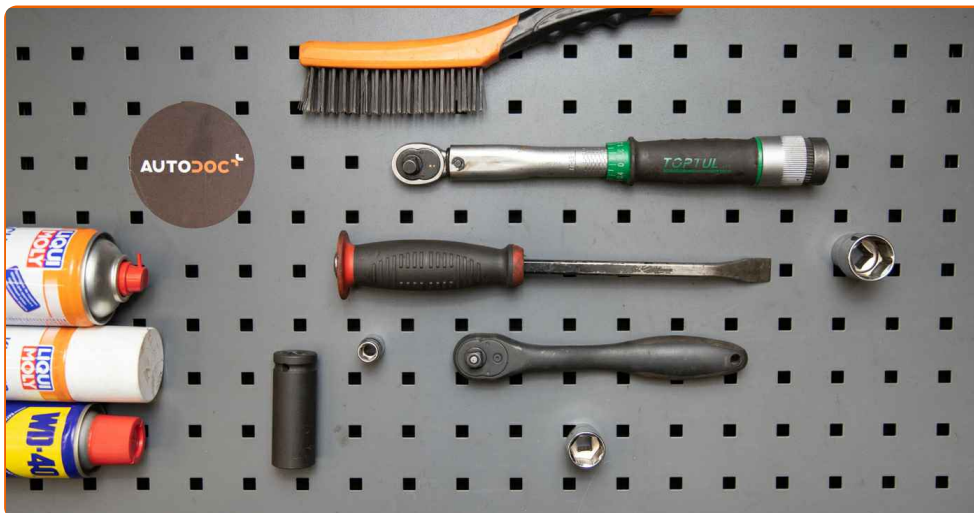

- Wire brush
- WD-40 spray
- Brake cleaner
- Copper grease
- Torque wrench
- Drive socket # 10
- Drive socket # 19
- Drive socket # 24
- Wheel impact socket #21
- Ratchet wrench
- Hydraulic transmission jack
- Crow bar
- Wheel chock

**BUY TOOLS**

Replacement: shock absorbers – Hyundai Santa Fe CM. Tip from AUTODOC experts:

- Both shock absorbers of the rear suspension should be replaced simultaneously.
- The replacement procedure is identical for the left and right shock absorbers of the rear suspension.
- Please note: all work on the car – Hyundai Santa Fe CM – should be done with the engine switched off.

**CARRY OUT REPLACEMENT IN THE FOLLOWING ORDER:**

1

Secure the wheels with chocks.



2

Loosen the wheel mounting bolts. Use wheel impact socket #21.



3

Raise the rear of the car and secure on supports.



**4** Unscrew the wheel bolts.



**AUTODOC recommends:**

- Warning! To avoid injury, hold the wheel while unscrewing the fastening bolts.  
Hyundai Santa Fe CM

**5** Remove the wheel.



**6** Support the rear knuckle. Use a hydraulic transmission jack.



**7** Unscrew the fasteners of the control arm cover. Use a drive socket #10. Use a ratchet wrench.



**8** Remove the control arm cover.

**9** Clean the shock absorber fasteners. Use a wire brush. Use WD-40 spray.

**10** Unscrew the lower fastener of the shock absorber. Use a drive socket #19. Use a ratchet wrench.



**11** Unscrew the upper fastener of the shock absorber. Use a drive socket #24. Use a ratchet wrench.

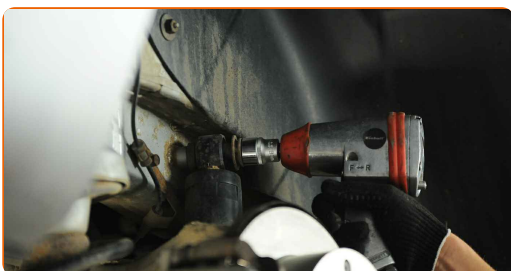

**12** Remove the fastening bolt.

**13** Remove the shock absorber. Use a crowbar.



**14** Clean the shock absorber mounting seats. Use a wire brush. Use WD-40 spray.

Replacement: shock absorbers – Hyundai Santa Fe CM. Professionals recommend:

- Before installing a new shock absorber you should pump it manually 3-5 times.

15

Place the shock absorber in the wheel arch and fasten it.

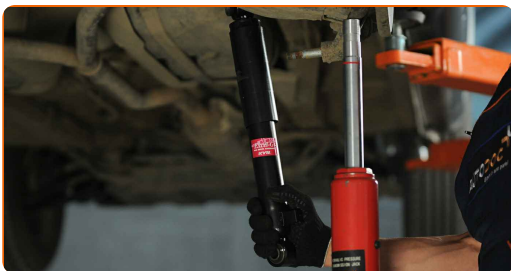

AUTODOC recommends:

- Hyundai Santa Fe CM – To avoid injury, hold the shock absorber while screwing in the fastening bolts.

16

Install the fastening bolt.

17

Screw in the lower fastener of the shock absorber. Use a drive socket #19.

18

Tighten the top shock absorber fastening. Use a drive socket #24. Use a torque wrench. Tighten it to 145 Nm torque.

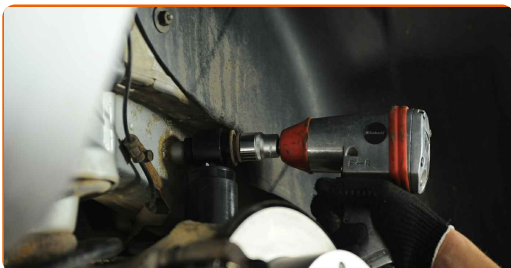

- 19 Tighten the lower fastener of the shock absorber. Use a drive socket #19. Use a torque wrench. Tighten it to 118 Nm torque.



- 20 Treat the shock absorber fasteners. Use copper grease.

- 21 Install the control arm cover.

- 22 Screw in the fasteners of the control arm cover. Use a drive socket #10. Use a ratchet wrench.

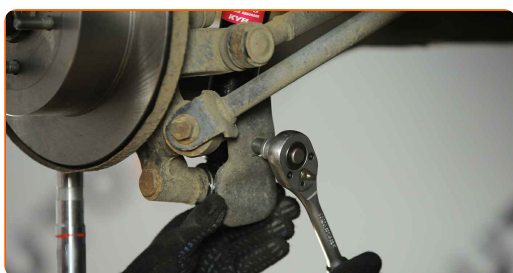

- 23 Remove the support from under the rear knuckle.



**AUTODOC recommends:**

- Replacement: shock absorbers – Hyundai Santa Fe CM. Lower the transmission jack smoothly, without jerks, to avoid damaging components and mechanisms.



24

Treat the surface where the brake disc contacts the wheel rim. Use copper grease.



25

Clean the brake disk surface. Use a brake cleaner.

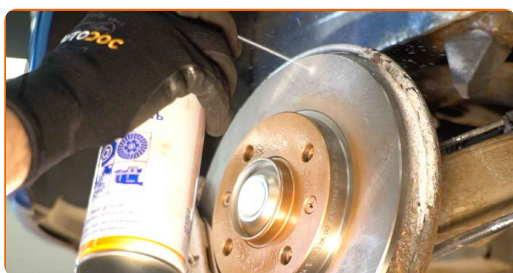

**AUTODOC recommends:**

- Replacement: shock absorbers – Hyundai Santa Fe CM. After applying the spray, wait a few minutes.

26

Install the wheel.



**AUTODOC recommends:**

- Warning! To avoid injury, hold the wheel while screwing in the fastening bolts on the car. Hyundai Santa Fe CM

**27** Screw in the wheel bolts. Use wheel impact socket #21.



**28** Lower the car and working in a cross order, tighten the wheel bolts. Use wheel impact socket #21. Use a torque wrench. Tighten it to 108 Nm torque.



**29** Remove the jacks and chocks.

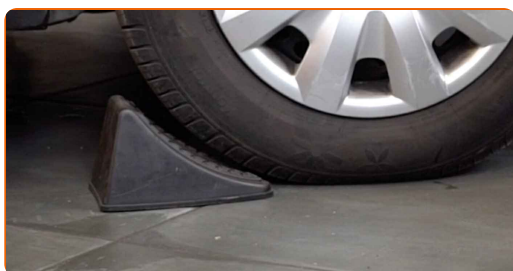

**WELL DONE!** 

**VIEW MORE TUTORIALS**

# AUTODOC – TOP QUALITY AND AFFORDABLE CAR PARTS ONLINE

**AUTODOC MOBILE APP: GREAT DEALS AND CONVENIENT SHOPPING**



**+ AUTODOC**

GET IT ON  
**Google Play**

Download on the  
**App Store**

**Download**

**A GREAT SELECTION OF SPARE PARTS FOR YOUR CAR**

**BUY SPARE PARTS FOR HYUNDAI**

**SHOCK ABSORBERS: A WIDE SELECTION**

**CHOOSE CAR PARTS FOR HYUNDAI SANTA FE CM**

**SHOCK ABSORBERS FOR HYUNDAI: BUY NOW**

**SHOCK ABSORBERS FOR HYUNDAI SANTA FE CM: THE  
BEST DEALS & OFFERS**

### **DISCLAIMER:**

The document contains only general recommendations that may be useful for you when you perform repair or replacement work. AUTODOC shall not be liable for any loss, injury, damage of property occurring in the repair or replacement process due to incorrect use or misinterpretation of the provided information.

AUTODOC shall not be liable for any possible mistakes and uncertainties in this guide. The information provided is for information purposes only and cannot replace advice from specialists.

AUTODOC shall not be liable for incorrect or hazardous usage of equipment, tools and car parts. AUTODOC strongly recommends to be careful and observe the safety rules when performing repair or replacement works. Remember: usage of low quality auto parts does not guarantee you the appropriate level of road safety.

© Copyright 2023 – All the contents of this website, in particular texts, photographs and graphics, are protected by copyright. All rights, including reproduction, publication, editing and translation rights, are reserved by AUTODOC GmbH.