



How to change rear  
wheel bearing on  
**RENAULT KANGOO**  
**Express (FW0/1\_)** –  
replacement guide

### SIMILAR VIDEO TUTORIAL



This video shows the replacement procedure of a similar car part on another vehicle

#### **ⓘ Important!**

This replacement procedure can be used for:

RENAULT KANGOO Express (FW0/1\_) 1.6 (FW00, FW0E, FW0N, FW0P, FW0Y),  
 RENAULT KANGOO Express (FW0/1\_) 1.6 16V (FW03, FW09, FW0D, FW0U, FW0W,  
 FW13), RENAULT KANGOO Express (FW0/1\_) 1.5 dCi 70 (FW0A, KW0V), RENAULT  
 KANGOO Express (FW0/1\_) 1.5 dCi 85 (FW0K, FW0L, FW0B), RENAULT KANGOO  
 Express (FW0/1\_) 1.5 dCi 105 (FW0F)

The steps may slightly vary depending on the car design.

This tutorial was created based on the replacement procedure for a similar car part on: NISSAN MICRA III (K12) 1.4 16V

**REPLACEMENT: WHEEL BEARING – RENAULT KANGOO EXPRESS (FW0/1\_). TOOLS YOU MIGHT NEED:**

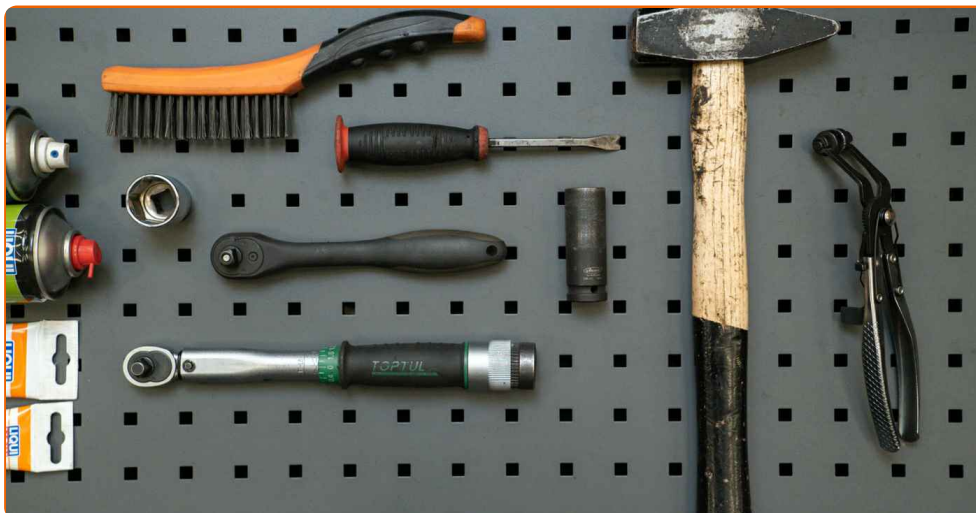

- Wire brush
- All-purpose cleaning spray
- Ceramic grease
- Torque wrench
- Drive socket # 30
- Wheel impact socket #17
- Ratchet wrench
- Tap wrench
- Crow bar
- Hammer
- Circlip pliers
- Bush and bearing driver set
- Wheel chock

**Buy tools**

Replacement: wheel bearing – RENAULT KANGOO Express (FW0/1\_).  
Professionals recommend:

- Do not re-use the bearing assembly of your RENAULT KANGOO Express (FW0/1\_) car.
- The wheel hub bearing replacement procedure is identical for both wheels on the same axle.
- All work should be done with the engine stopped.

**REPLACEMENT: WHEEL BEARING – RENAULT KANGOO EXPRESS (FW0/1\_). TAKE THE FOLLOWING STEPS:**

**1** Secure the wheels with chocks.

**2** Loosen the wheel bolts. Use wheel impact socket #17. Use a tap wrench.



**3** Raise the car.

Replacement: wheel bearing – RENAULT KANGOO Express (FW0/1\_).  
AUTODOC experts recommend:

- If you are using a jack, make sure it rests on a flat surface without any unevenness.
- Be sure to additionally secure the car with jack stands.

**4** Unscrew the wheel bolts.



**AUTODOC recommends:**

- To avoid injury, hold up the wheel when unscrewing the bolts.

**5** Remove the wheel.

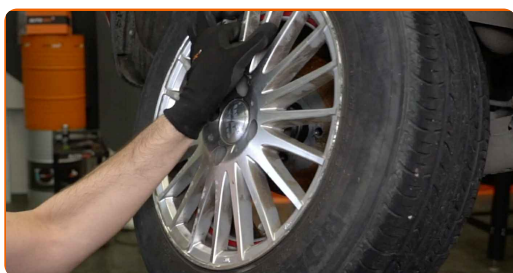

**6** Remove the hub bearing cap. Use a crowbar. Use a hammer.

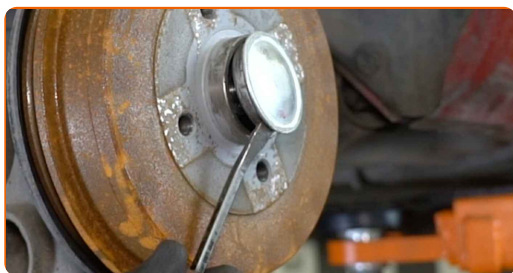

**7** Unscrew the wheel hub fastener. Use a drive socket #30. Use a tap wrench.

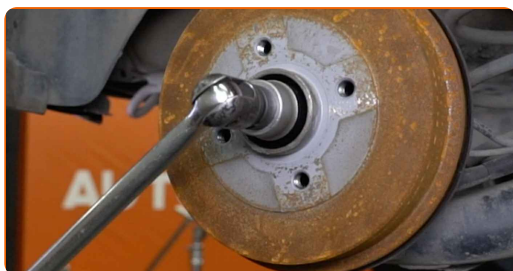

**8** Remove the fastening nut.



**9** Remove the brake drum assembled with the wheel hub bearing.

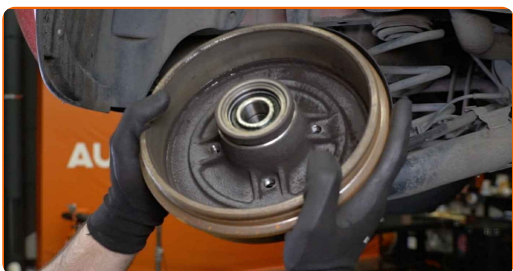

Replacement: wheel bearing – RENAULT KANGOO Express (FW0/1\_). Tip:

- Examine the brake drum. Replace it if necessary.

**10** Remove the wheel hub bearing retaining ring. Use circlip pliers.



**11** Press out the wheel hub bearing. Use a bush and bearing driver set.



**12**

Clean the hub bearing mounting seat. Use a wire brush.



**13**

Press fit the new wheel hub bearing into the brake drum. Use a bush and bearing driver set.



**AUTODOC recommends:**

- Check to make sure the wheel hub bearing is positioned correctly. Avoid its misalignment.
- Stop pressing on the surface of the bearing immediately after it has been fitted into its mounting seat.

**14**

Install the wheel hub bearing retaining ring. Use circlip pliers.



**15** Clean the hub bearing mounting seat. Use all-purpose cleaning spray.

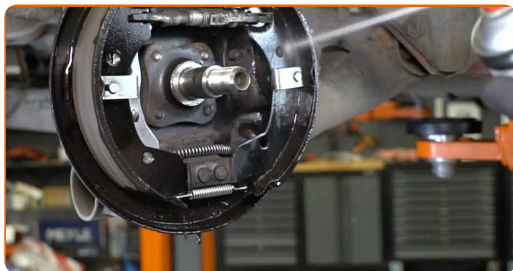

**16** Install the brake drum assembled with the wheel hub bearing.

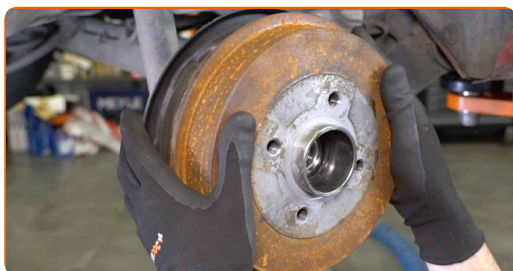

**17** Install the fastening nut.



**18** Tighten the hub fastener. Use a drive socket #30. Use a torque wrench. Tighten it to 175 Nm torque.

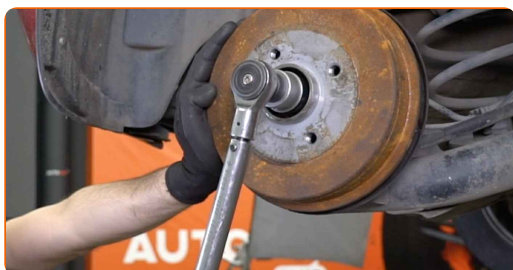



Replacement: wheel bearing – RENAULT KANGOO Express (FW0/1\_).  
AUTODOC experts recommend:

- Important! Be sure to use new fasteners.

19

Install the hub bearing cap. Use a bush and bearing driver set. Use a hammer.



20

Clean the wheel rim mounting seat. Use a wire brush. Use all-purpose cleaning spray.

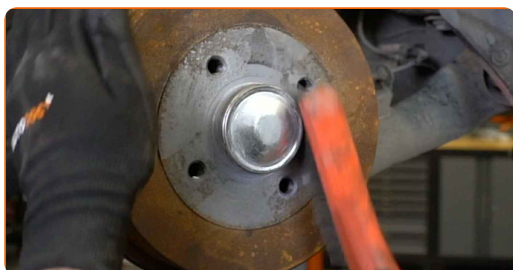

21

Treat the surface where the wheel rim contacts the brake drum. Use ceramic grease.



22

Install the wheel.



**AUTODOC recommends:**

- Warning! To avoid injury, hold the wheel while screwing in the fastening bolts on the car. RENAULT KANGOO Express (FW0/1\_)

23

Screw in the wheel bolts. Use wheel impact socket #17. Use a ratchet wrench.



24

Lower the car and working in a cross order, tighten the wheel bolts. Use wheel impact socket #17. Use a torque wrench. Tighten it to 110 Nm torque.



25

Remove the jacks and chocks.



**WELL DONE!** 

**VIEW MORE TUTORIALS**

# AUTODOC – TOP QUALITY AND AFFORDABLE CAR PARTS ONLINE

**AUTODOC MOBILE APP: GREAT DEALS AND CONVENIENT SHOPPING**



**+ AUTODOC**

GET IT ON  
**Google Play**

 Download on the  
**App Store**

**Download**

**A GREAT SELECTION OF SPARE PARTS FOR YOUR CAR**

**WHEEL BEARING: A WIDE SELECTION**

## **DISCLAIMER:**

The document contains only general recommendations that may be useful for you when you perform repair or replacement work. AUTODOC shall not be liable for any loss, injury, damage of property occurring in the repair or replacement process due to incorrect use or misinterpretation of the provided information.

AUTODOC shall not be liable for any possible mistakes and uncertainties in this guide. The information provided is for information purposes only and cannot replace advice from specialists.

AUTODOC shall not be liable for incorrect or hazardous usage of equipment, tools and car parts. AUTODOC strongly recommends to be careful and observe the safety rules when performing repair or replacement works. Remember: usage of low quality auto parts does not guarantee you the appropriate level of road safety.

© Copyright 2023 – All the contents of this website, in particular texts, photographs and graphics, are protected by copyright. All rights, including reproduction, publication, editing and translation rights, are reserved by AUTODOC SE.