



How to change pollen
filter on **Toyota RAV4 III**
– replacement guide

VIDEO TUTORIAL



Important!

This replacement procedure can be used for:

TOYOTA Urban Cruiser (_P1_) 1.33 (NSP110_), TOYOTA AURIS (NRE15_, ZZE15_, ADE15_, ZRE15_, NDE15_) 1.8 (ZRE152_), TOYOTA Yaris Hatchback (_P13_) 1.3 (NSP130_), TOYOTA Yaris Hatchback (_P13_) 1.0 (KSP130_), TOYOTA LAND CRUISER (VDJ20_, UZJ20_) 4.6 V8, TOYOTA Verso S (_P12_) 1.33 (NSP120_), TOYOTA Verso S (_P12_) 1.4 D4-D (NLP121_), TOYOTA Yaris Hatchback (_P9_) 1.3 VVT-i (NCP90_, SCP90_), TOYOTA Camry Saloon (_V5_) 2.5, TOYOTA Sequoia II (XK60) 5.7 4WD (USK65_), TOYOTA LAND CRUISER (VDJ20_, UZJ20_) 5.7 V8 (URJ200_), TOYOTA LAND CRUISER 150 (KDJ15_, GRJ15_) 2.7 (TRJ150_, TRJ155_), TOYOTA LAND CRUISER 150 (KDJ15_, GRJ15_) 4.0 V6 VVTi (GRJ150_), TOYOTA Tundra Pickup (_K5_, _K6_) 5.7 4WD (USK50_, USK51_, USK52_, USK56_, USK57_), TOYOTA PRIUS PLUS (ZVW4_) 1.8 Hybrid (ZVW4_), (+ 159)

The steps may slightly vary depending on the car design.

Replacement: pollen filter – Toyota RAV4 III. Tip from AUTODOC:

- Replace the cabin filter at least once every six months, in early spring and autumn seasons.
- Follow the terms, recommendations and requirements of the part operation provided by the manufacturer.
- If the air flow into the cabin has sharply reduced, replace the filter before a scheduled maintenance.
- Warning! Shut down the engine before starting any work – Toyota RAV4 III.

CARRY OUT REPLACEMENT IN THE FOLLOWING ORDER:

1

Open the glove box.



2

Detach the stopper (strap) from the glove box lid.

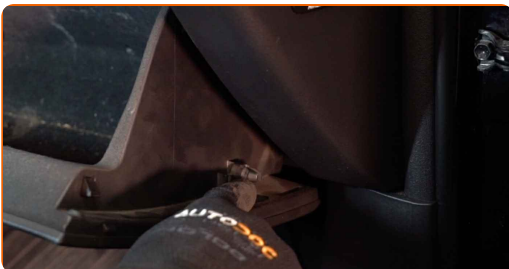

3 Release the cabin filter cover clips.

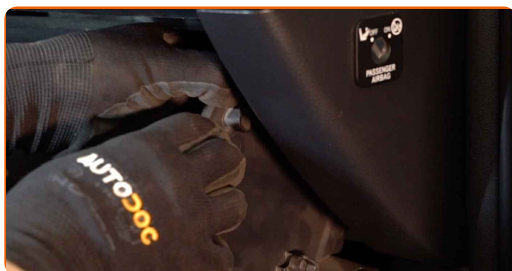

4 Remove the cabin filter housing cover.



AUTODOC recommends:

- Replacement: pollen filter – Toyota RAV4 III. To avoid damaging the part when removing it, do not use excessive force.

5 Remove the cabin filter.



AUTODOC recommends:

- Do not attempt to clean and reuse the filter - it will affect the quality of air cleaning inside the car.

6 Install the cabin filter to its mounting seat.

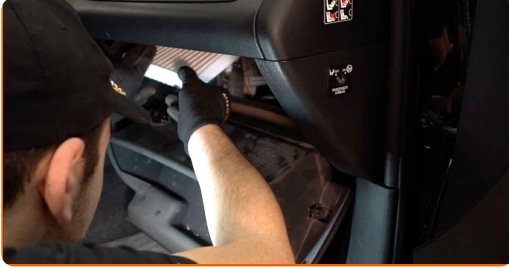

Replacement: pollen filter – Toyota RAV4 III. Tip from AUTODOC experts:

- Check out the correct location of the filter element. Do not skew.
- Follow the air flow direction arrow on the filter.
- Toyota RAV4 III – It's important to only use high-quality filters.

7 Reinstall the cabin filter housing cover. Make sure you hear a click indicating that it is locked in place.

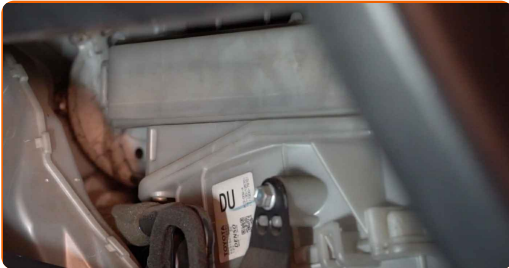

8 Attach the stopper (strap) to the glove box lid.

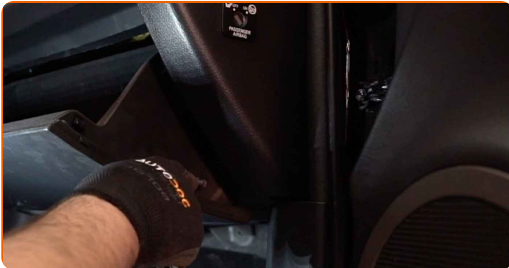

9

Close the glove box.



10

Switch on the ignition.



11

Switch on the air conditioning system. This is necessary in order to make sure that the component operates properly.

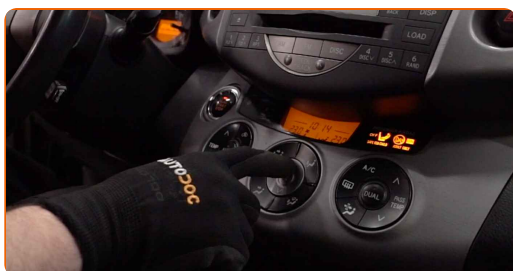

12

Switch off the ignition.

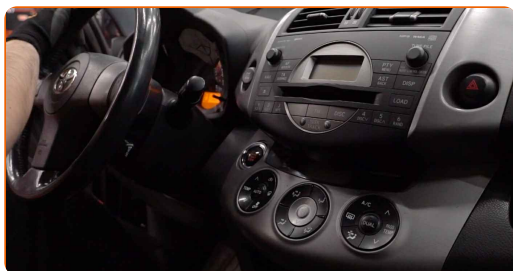

WELL DONE! 

VIEW MORE TUTORIALS

AUTODOC – TOP QUALITY AND AFFORDABLE CAR PARTS ONLINE

AUTODOC MOBILE APP: GREAT DEALS AND CONVENIENT SHOPPING



+ AUTODOC

GET IT ON  **Google Play**

 **Download on the App Store**

Download

A GREAT SELECTION OF SPARE PARTS FOR YOUR CAR

BUY SPARE PARTS FOR TOYOTA

POLLEN FILTER: A WIDE SELECTION

CHOOSE CAR PARTS FOR TOYOTA RAV4 III

POLLEN FILTER FOR TOYOTA: BUY NOW

POLLEN FILTER FOR TOYOTA RAV4 III: THE BEST DEALS & OFFERS

DISCLAIMER:

The document contains only general recommendations that may be useful for you when you perform repair or replacement work. AUTODOC shall not be liable for any loss, injury, damage of property occurring in the repair or replacement process due to incorrect use or misinterpretation of the provided information.

AUTODOC shall not be liable for any possible mistakes and uncertainties in this guide. The information provided is for information purposes only and cannot replace advice from specialists.

AUTODOC shall not be liable for incorrect or hazardous usage of equipment, tools and car parts. AUTODOC strongly recommends to be careful and observe the safety rules when performing repair or replacement works. Remember: usage of low quality auto parts does not guarantee you the appropriate level of road safety.

© Copyright 2023 – All the contents of this website, in particular texts, photographs and graphics, are protected by copyright. All rights, including reproduction, publication, editing and translation rights, are reserved by AUTODOC SE.