



How to change spark
plugs on **PEUGEOT**
EXPERT
Platform/Chassis –
replacement guide

SIMILAR VIDEO TUTORIAL



This video shows the replacement procedure of a similar car part on another vehicle

Important!

This replacement procedure can be used for:
PEUGEOT EXPERT Platform/Chassis 2.0 16V (X_RFH)

The steps may slightly vary depending on the car design.

This tutorial was created based on the replacement procedure for a similar car part on: PEUGEOT 206 Hatchback (2A/C) 1.6

**REPLACEMENT: SPARK PLUGS – PEUGEOT EXPERT
PLATFORM/CHASSIS. TOOLS YOU'LL NEED:**



- High-temperature anti-seize lubricant
- Torx bit T20
- Torx bit T27
- Spark plug socket # 16
- Ratchet wrench
- Torque wrench
- Flat Screwdriver
- Crow bar
- Fender cover

Buy tools

Replacement: spark plugs – PEUGEOT EXPERT Platform/Chassis. Tip from AUTODOC experts:

- The replacement procedure is the same for all spark plugs.
- Please note: all work on the car – PEUGEOT EXPERT Platform/Chassis – should be done with the engine switched off.

CARRY OUT REPLACEMENT IN THE FOLLOWING ORDER:

1 Open the hood.

2 Use a fender protection cover to prevent damaging paintwork and plastic parts of the car.

3 Unscrew the engine cover fastener. Use Torx T20.



4 Remove the engine cover.



Replacement: spark plugs – PEUGEOT EXPERT Platform/Chassis. AUTODOC recommends:

- Raise the engine cover, holding it on two sides simultaneously.

5 Remove the crankcase ventilation hoses.



6 Detach the connector from the ignition coil.



7 Unscrew the ignition coil bracket. Use Torx T27.



8 Pry up the ignition coil. Use a crowbar.



9 Take out the ignition coil from the spark plug well.



10 Clean dirt, dust and debris from inside the spark plug wells.

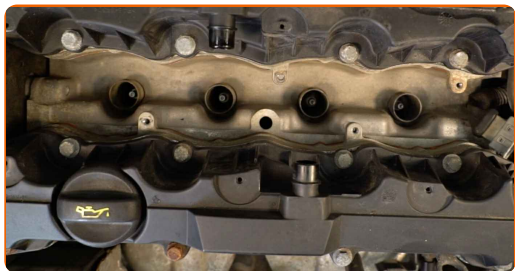

11 Unscrew the spark plugs. Use the spark plug socket #16. Use a ratchet wrench.



12 Take out the spark plugs.

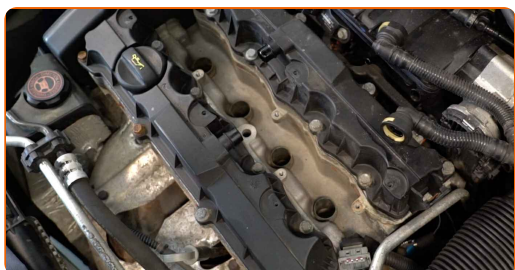

13 Apply a thin layer of a special high temperature anti-seize lubricant to the threads of the new spark plugs.

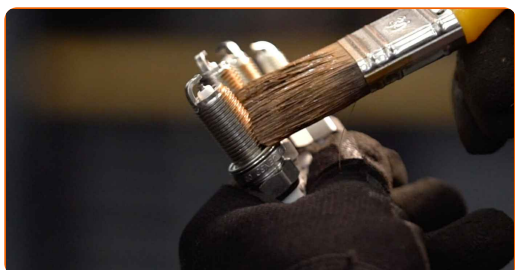

14

Install the new spark plugs into their mounting seats. Use the spark plug socket #16.



15

Screw new spark plugs and tighten them. Use the spark plug socket #16. Use a torque wrench. Tighten it to 26 nm torque.



Replacement: spark plugs – PEUGEOT EXPERT Platform/Chassis.
Professionals recommend:

- Don't tighten the plugs with excessive force. Exceeding tightening torque can damage the thread connection.
- Be careful when working with a spark plug wrench. Its skewing can cause damage to the threaded connection.

16

Treat the ignition coil tips. Use high-temperature grease. Use a flat screwdriver.



17 Plug in the ignition coil connector.



18 Install the ignition coils to the spark plug wells. Make sure you hear a click indicating that it is locked in place.



19 Tighten the fasteners of the ignition coils. Use Torx T20. Use a torque wrench. Tighten it to 8 nm torque.

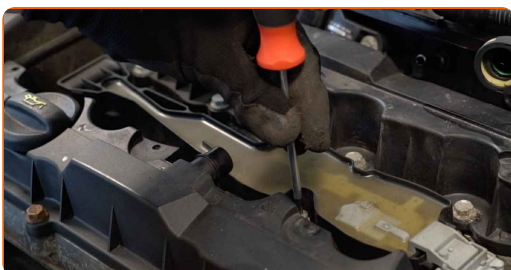

20 Install the crankcase ventilation hoses.

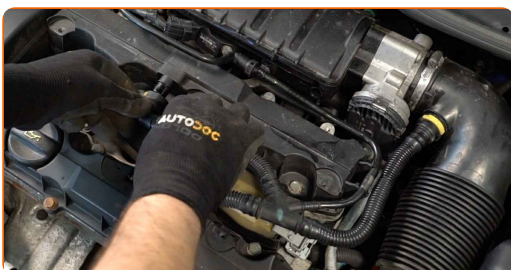

21

Install the engine cover and secure it. Screw in the engine cover fasteners. Use Torx T20.



AUTODOC recommends:

- Make sure the engine cover is properly seated. It should not be displaced with respect to the guiding fasteners and the throttle body air intake hose.
- Replacement: spark plugs – PEUGEOT EXPERT Platform/Chassis. Do not use excessive force during installation. This may damage the fasteners.

22

Run the engine for a few minutes. This is necessary in order to make sure that the component operates properly.

23

Shut off the engine.

24

Remove the fender protection cover.

25

Close the hood.

WELL DONE! 

VIEW MORE TUTORIALS

AUTODOC – TOP QUALITY AND AFFORDABLE CAR PARTS ONLINE

AUTODOC MOBILE APP: GREAT DEALS AND CONVENIENT SHOPPING



+ AUTODOC

GET IT ON
Google Play

 Download on the
App Store

Download

A GREAT SELECTION OF SPARE PARTS FOR YOUR CAR

SPARK PLUGS: A WIDE SELECTION

DISCLAIMER:

The document contains only general recommendations that may be useful for you when you perform repair or replacement work. AUTODOC shall not be liable for any loss, injury, damage of property occurring in the repair or replacement process due to incorrect use or misinterpretation of the provided information.

AUTODOC shall not be liable for any possible mistakes and uncertainties in this guide. The information provided is for information purposes only and cannot replace advice from specialists.

AUTODOC shall not be liable for incorrect or hazardous usage of equipment, tools and car parts. AUTODOC strongly recommends to be careful and observe the safety rules when performing repair or replacement works. Remember: usage of low quality auto parts does not guarantee you the appropriate level of road safety.

© Copyright 2023 – All the contents of this website, in particular texts, photographs and graphics, are protected by copyright. All rights, including reproduction, publication, editing and translation rights, are reserved by AUTODOC SE.