



How to change rear strut
mount on **PEUGEOT 406**
Estate – replacement
guide

SIMILAR VIDEO TUTORIAL



This video shows the replacement procedure of a similar car part on another vehicle

Important!

This replacement procedure can be used for:

PEUGEOT 406 Estate 1.9 D, PEUGEOT 406 Estate 1.8 16V, PEUGEOT 406 Estate 1.9 TD, PEUGEOT 406 Estate 2.1 TD 12V, PEUGEOT 406 Estate 2.0 Turbo, PEUGEOT 406 Estate 2.0 16V, PEUGEOT 406 Estate 3.0 24V, PEUGEOT 406 Estate 1.8, PEUGEOT 406 Estate 2.0 HDI 110, PEUGEOT 406 Estate 2.0 HDI 90, PEUGEOT 406 Estate 3.0 V6, PEUGEOT 406 Estate 2.2, PEUGEOT 406 Estate 2.2 HDI, PEUGEOT 406 Estate 2.0 16V HPi, PEUGEOT 406 Estate 2.0 HDi 110

The steps may slightly vary depending on the car design.

This tutorial was created based on the replacement procedure for a similar car part on: PEUGEOT 406 Saloon 2.2

**REPLACEMENT: STRUT MOUNT – PEUGEOT 406
ESTATE. LIST OF THE TOOLS YOU'LL NEED:**

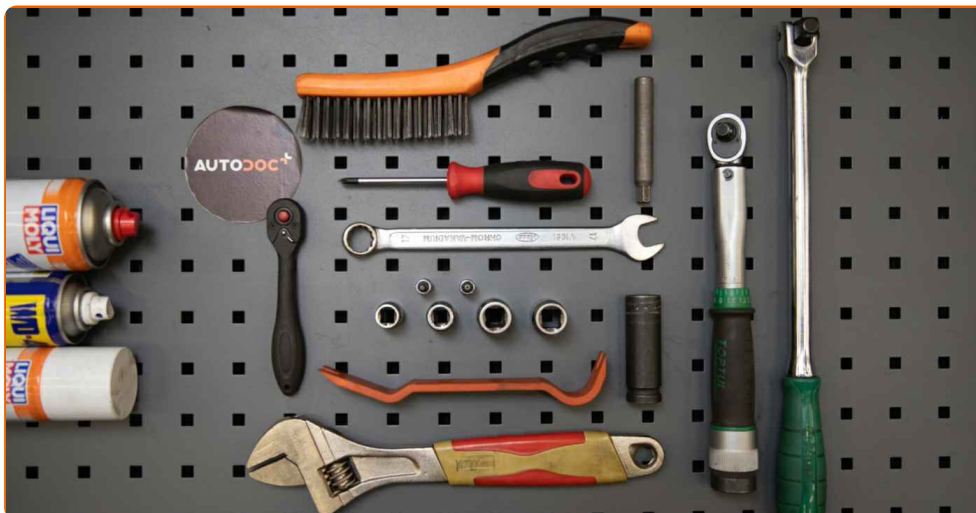

- Wire brush
- WD-40 spray
- Brake cleaner
- Copper grease
- High-temperature ceramic grease
- Drive socket # 15
- Drive socket # 18
- Wheel impact socket #19
- Ratchet wrench
- Torque wrench
- Flat Screwdriver
- Clip removal tool
- Adjustable wrench
- Hydraulic transmission jack
- Rubber mallet
- Wheel chock

Buy tools

Replacement: strut mount – PEUGEOT 406 Estate. AUTODOC experts recommend:

- The replacement procedure is identical for the mounts of the right and left shock absorbers of the rear suspension.
- Both mounts of the rear shock struts should be replaced simultaneously.
- Be sure to replace all self-locking nuts and bolts during installation.
- All work should be done with the engine stopped.

REPLACEMENT: STRUT MOUNT – PEUGEOT 406 ESTATE. USE THE FOLLOWING PROCEDURE:

1 Secure the wheels with chocks.



2 Loosen the wheel mounting bolts. Use wheel impact socket #19.



3 Raise the rear of the car and secure on supports.

4 Unscrew the wheel bolts.

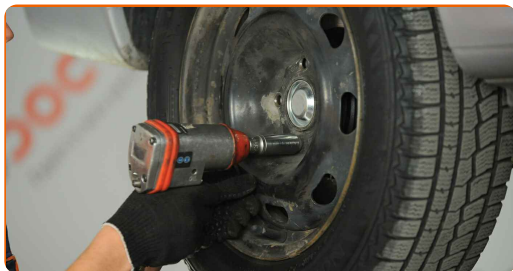

AUTODOC recommends:

- Warning! To avoid injury, hold the wheel while unscrewing the fastening bolts.
PEUGEOT 406 Estate

5 Remove the wheel.



6 Support the rear control arm. Use a hydraulic transmission jack.



7 Clean the shock absorber fasteners. Use a wire brush. Use WD-40 spray.

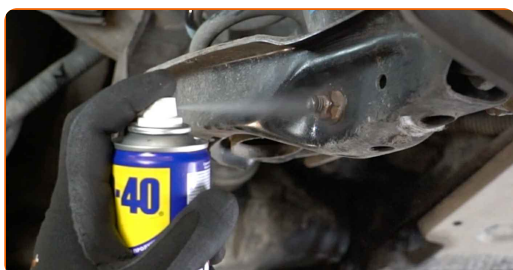

- 8** Unscrew the lower fastener of the shock absorber. Use a combination spanner #18. Use a drive socket #18. Use a ratchet wrench.

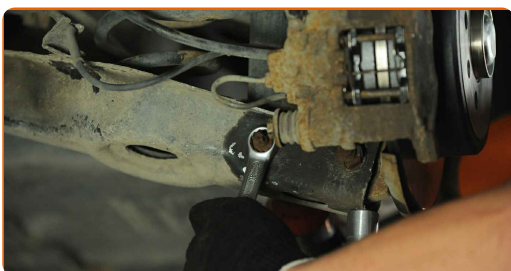

- 9** Remove the fastening bolt.

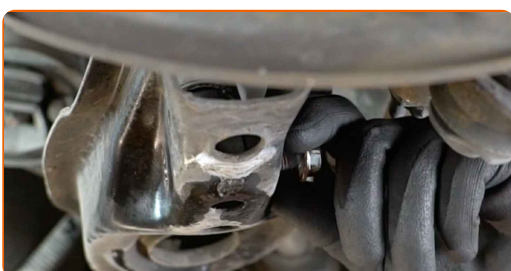

- 10** Remove the support from under the rear control arm.

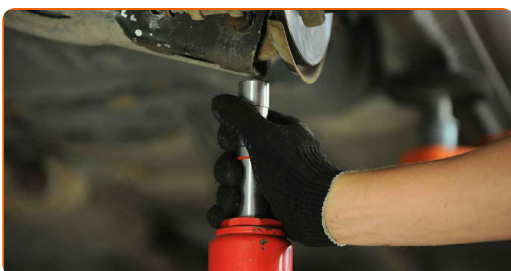

AUTODOC recommends:

- Replacement: strut mount – PEUGEOT 406 Estate. Lower the transmission jack smoothly, without jerks, to avoid damaging components and mechanisms.

- 11** Lower the car.

- 12** Open the luggage compartment.

13

Remove the clips of the boot side lining. Use a clip removal tool.

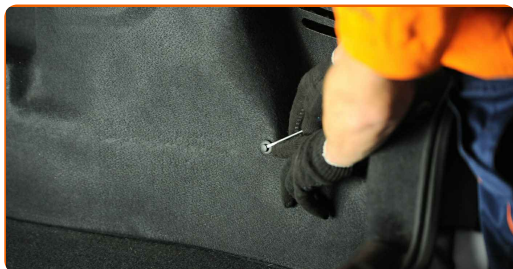

14

Detach the boot side lining.

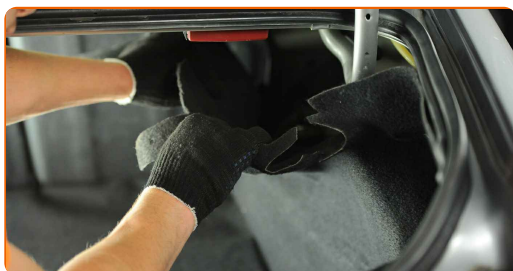

15

Clean the upper fastener of the shock absorber. Use a wire brush. Use WD-40 spray.

16

Unscrew the upper fastener of the shock absorber. Use a combination spanner #17. Use an adjustable wrench.

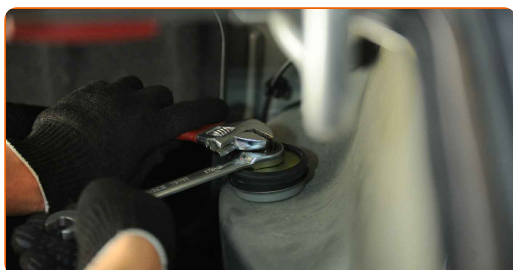

AUTODOC recommends:

- PEUGEOT 406 Estate – To avoid injury, hold the shock absorber while unscrewing the fastening bolts.

17 Remove the shock absorber.

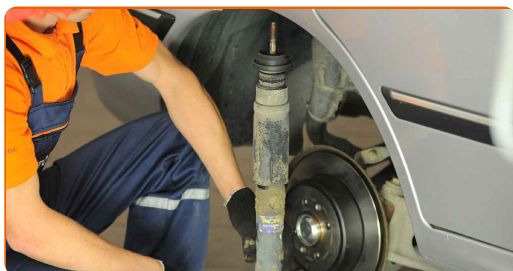

18 Remove the shock absorber upper mount.

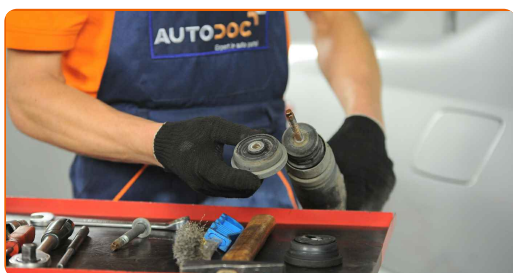

19 Install the new shock absorber mount.

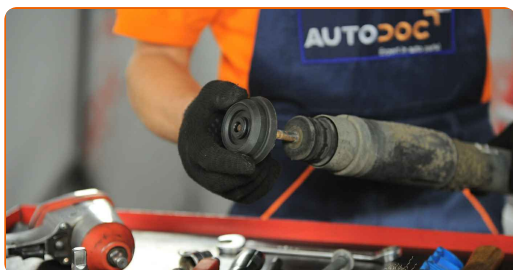

20 Clean the shock absorber mounting seats. Use a wire brush. Use WD-40 spray.

21 Place the shock absorber in the wheel arch and secure it.



AUTODOC recommends:

- PEUGEOT 406 Estate – To avoid injury, hold the shock absorber while screwing in the fastening bolts.

- 22** Tighten the top shock absorber fastening. Use a combination spanner #17. Use an adjustable wrench. Use a torque wrench. Tighten it to 35 Nm torque.

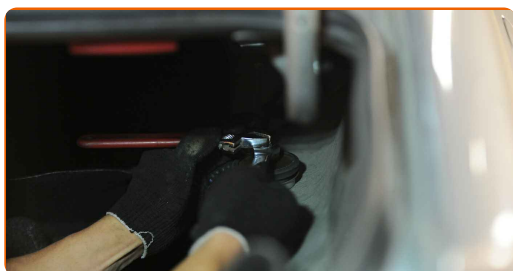

- 23** Attach the side lining of the boot.



- 24** Install the clips of the boot side lining.

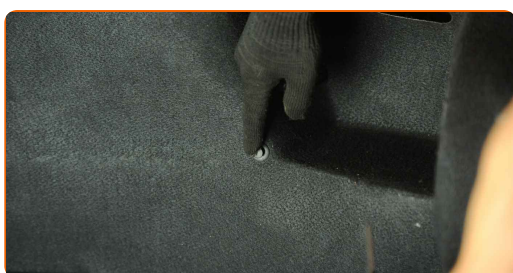

- 25** Close the luggage compartment.

- 26** Raise the rear of the car and secure on supports.

- 27** Support the rear control arm. Use a hydraulic transmission jack.

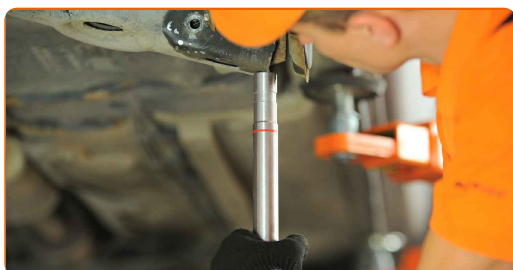

28 Install the fastening bolt.



29 Tighten the lower fastener of the shock absorber. Use a combination spanner #18. Use a drive socket #18. Use a torque wrench. Tighten it to 75 Nm torque.

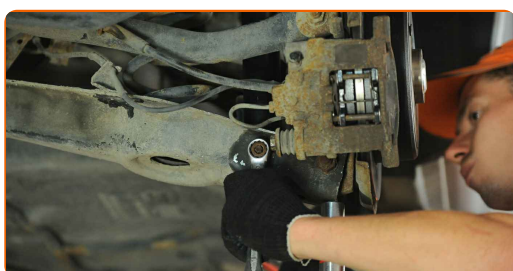

30 Remove the support from under the rear control arm.

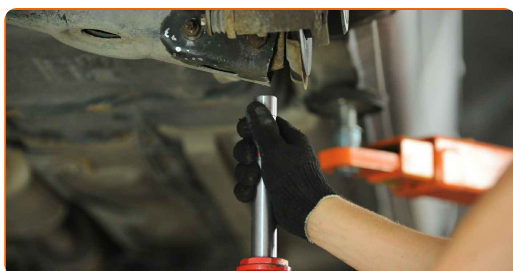

AUTODOC recommends:

- Replacement: strut mount – PEUGEOT 406 Estate. Lower the transmission jack smoothly, without jerks, to avoid damaging components and mechanisms.

31 Treat the shock absorber fasteners. Use copper grease.

32 Treat the surface where the brake disc contacts the wheel rim. Use high-temperature ceramic grease.



33 Clean the brake disk surface. Use a brake cleaner.



AUTODOC recommends:

- Replacement: strut mount – PEUGEOT 406 Estate. After applying the spray, wait a few minutes.

34 Install the wheel.



AUTODOC recommends:

- Warning! To avoid injury, hold the wheel while screwing in the fastening bolts on the car. PEUGEOT 406 Estate

35

Screw in the wheel bolts. Use wheel impact socket #19.

**36**

Lower the car and working in a cross order, tighten the wheel bolts. Use wheel impact socket #19. Use a torque wrench. Tighten it to 90 nm torque.

**37**

Remove the jacks and chocks.

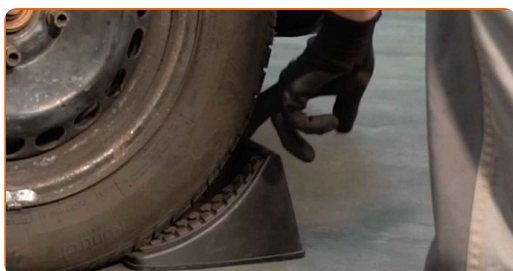

WELL DONE! 

VIEW MORE TUTORIALS

AUTODOC – TOP QUALITY AND AFFORDABLE CAR PARTS ONLINE

AUTODOC MOBILE APP: GREAT DEALS AND CONVENIENT SHOPPING



+ AUTODOC

GET IT ON
Google Play

Download on the
App Store

Download

A GREAT SELECTION OF SPARE PARTS FOR YOUR CAR

STRUT MOUNT: A WIDE SELECTION

DISCLAIMER:

The document contains only general recommendations that may be useful for you when you perform repair or replacement work. AUTODOC shall not be liable for any loss, injury, damage of property occurring in the repair or replacement process due to incorrect use or misinterpretation of the provided information.

AUTODOC shall not be liable for any possible mistakes and uncertainties in this guide. The information provided is for information purposes only and cannot replace advice from specialists.

AUTODOC shall not be liable for incorrect or hazardous usage of equipment, tools and car parts. AUTODOC strongly recommends to be careful and observe the safety rules when performing repair or replacement works. Remember: usage of low quality auto parts does not guarantee you the appropriate level of road safety.

© Copyright 2023 – All the contents of this website, in particular texts, photographs and graphics, are protected by copyright. All rights, including reproduction, publication, editing and translation rights, are reserved by AUTODOC SE.