



How to change glass for
wing mirror on
MERCEDES-BENZ W124
Estate (S124) –
replacement guide

SIMILAR VIDEO TUTORIAL



This video shows the replacement procedure of a similar car part on another vehicle

ⓘ Important!

This replacement procedure can be used for:

MERCEDES-BENZ W124 Estate (S124) 200 2.0 (124.080), MERCEDES-BENZ W124 Estate (S124) 200 TE 2.0 (124.081), MERCEDES-BENZ W124 Estate (S124) 200 TE 2.0, MERCEDES-BENZ W124 Estate (S124) 230 TE 2.3 KAT (124.083), MERCEDES-BENZ W124 Estate (S124) 230 TE 2.3 (124.083), MERCEDES-BENZ W124 Estate (S124) 300 TE 3.0 4-matic (124.290), MERCEDES-BENZ W124 Estate (S124) 300 TE 3.0 (124.090), MERCEDES-BENZ W124 Estate (S124) 200 D 2.0 (124.180), MERCEDES-BENZ W124 Estate (S124) 250 D 2.5 (124.185), MERCEDES-BENZ W124 Estate (S124) 300 D 3.0 (124.190), MERCEDES-BENZ W124 Estate (S124) 300 Turbo diesel 3.0 4-matic (124.393), MERCEDES-BENZ W124 Estate (S124) 300 TE-24 3.0 (124.091), MERCEDES-BENZ W124 Estate (S124) 260 TE 2.6 FGST., MERCEDES-BENZ W124 Estate (S124) 260 TE FGST. 2.6, MERCEDES-BENZ W124 Estate (S124) 220 TE 2.2 (124.082), (+ 6)

The steps may slightly vary depending on the car design.

Please note that this tutorial was created based on the replacement procedure for this car part on a car with a similar design.

This tutorial was created based on the replacement procedure for a similar car part on: MERCEDES-BENZ E-Class Saloon (W124) E 250 D (124.126, 124.129)

REPLACEMENT: GLASS FOR WING MIRROR –
 MERCEDES-BENZ W124 ESTATE (S124). LIST OF THE
 TOOLS YOU'LL NEED:



- Dielectric grease
- Plastic trim tool
- Fender cover

Buy tools

Replacement: glass for wing mirror – MERCEDES-BENZ W124 Estate (S124).
Tip from AUTODOC experts:

- The replacement procedure is identical for the right and left side mirror glass.
- Please note: all work on the car – MERCEDES-BENZ W124 Estate (S124) – should be done with the engine switched off.

CARRY OUT REPLACEMENT IN THE FOLLOWING ORDER:

1 Turn the mirror glass all the way inward.



2 Use a fender protection cover to prevent damaging paintwork and plastic parts of the car.

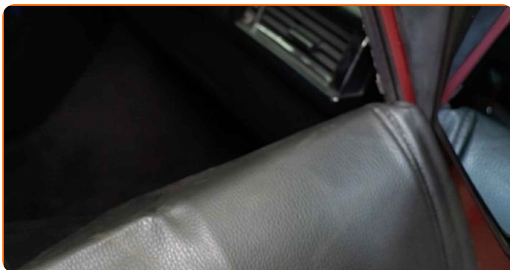

3 Carefully release the mirror glass from its attachment. Use a plastic trim tool.

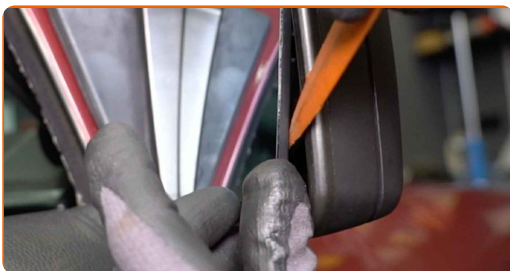

4 Remove the mirror glass.

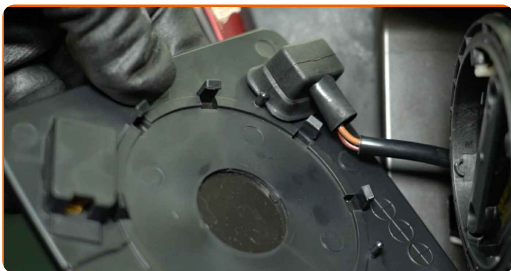

5 Detach the mirror heater connector.

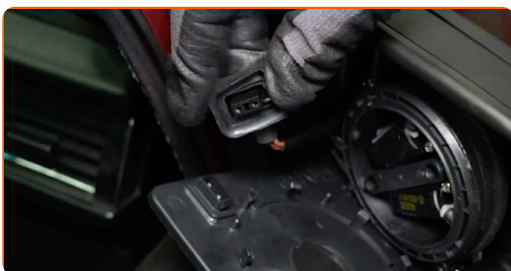

6 Treat the mirror heater connector. Use dielectric grease.

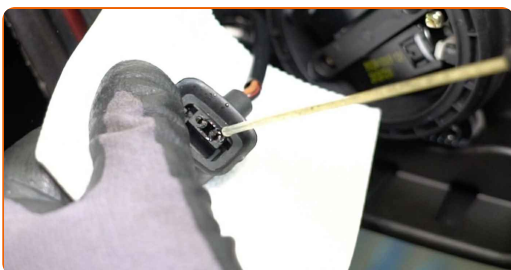

7 Attach the mirror heater connector.

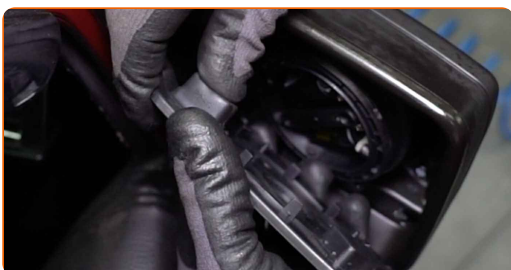

8 Install the new mirror glass.

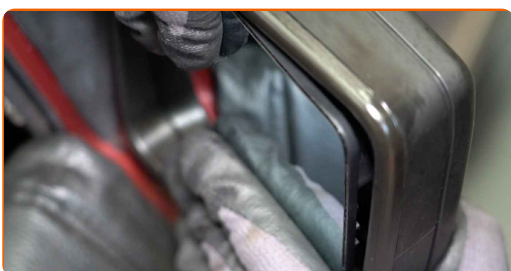

Replacement: glass for wing mirror – MERCEDES-BENZ W124 Estate (S124).

Tip:

- Make sure you hear a click indicating that it is locked in place.
- When installing, do not use excessive force to avoid damage to the part.
- Make sure the mirror glass is positioned correctly. It should be aligned with the locking tabs on the housing.

9

Adjust the mirror glass.



10

Remove the fender protection cover.

WELL DONE! [VIEW MORE TUTORIALS](#)

AUTODOC – TOP QUALITY AND AFFORDABLE CAR PARTS ONLINE

AUTODOC MOBILE APP: GREAT DEALS AND CONVENIENT SHOPPING



+ AUTODOC

GET IT ON
Google Play

Download on the
App Store

Download

A GREAT SELECTION OF SPARE PARTS FOR YOUR CAR

GLASS FOR WING MIRROR: A WIDE SELECTION

DISCLAIMER:

The document contains only general recommendations that may be useful for you when you perform repair or replacement work. AUTODOC shall not be liable for any loss, injury, damage of property occurring in the repair or replacement process due to incorrect use or misinterpretation of the provided information.

AUTODOC shall not be liable for any possible mistakes and uncertainties in this guide. The information provided is for information purposes only and cannot replace advice from specialists.

AUTODOC shall not be liable for incorrect or hazardous usage of equipment, tools and car parts. AUTODOC strongly recommends to be careful and observe the safety rules when performing repair or replacement works. Remember: usage of low quality auto parts does not guarantee you the appropriate level of road safety.

© Copyright 2023 – All the contents of this website, in particular texts, photographs and graphics, are protected by copyright. All rights, including reproduction, publication, editing and translation rights, are reserved by AUTODOC SE.