



How to change wing  
mirror on **Mercedes**  
**W201** – replacement  
guide

## VIDEO TUTORIAL



### Important!

This replacement procedure can be used for:

MERCEDES-BENZ 190 (W201) E 1.8 (201.018), MERCEDES-BENZ 190 (W201) 2.0 (201.022), MERCEDES-BENZ 190 (W201) E 2.0 (201.024), MERCEDES-BENZ 190 (W201) 2.0 (201.023), MERCEDES-BENZ 190 (W201) E 2.0, MERCEDES-BENZ 190 (W201) E 2.3, MERCEDES-BENZ 190 (W201) E 2.3 (201.028), MERCEDES-BENZ 190 (W201) E 2.6, MERCEDES-BENZ 190 (W201) D 2.0 (201.122), MERCEDES-BENZ 190 (W201) D 2.5 (201.126), MERCEDES-BENZ 190 (W201) Turbo-D 2.5 (201.128), MERCEDES-BENZ 190 (W201) E 2.6 (201.029), MERCEDES-BENZ Saloon (W124) 200 2.0 (124.020), MERCEDES-BENZ Saloon (W124) 200 E (124.021), MERCEDES-BENZ Saloon (W124) 200 E 2.0 (124.021), (+ 69)

The steps may slightly vary depending on the car design.

REPLACEMENT: WING MIRROR – MERCEDES W201.  
TOOLS YOU MIGHT NEED:

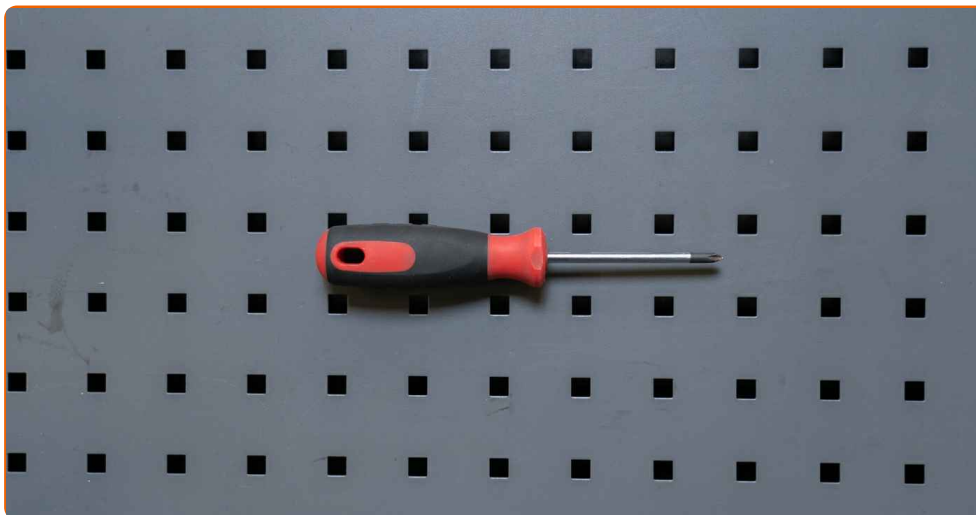

• Phillips screwdriver

• Fender cover

**BUY TOOLS**

Replacement: wing mirror – Mercedes W201. AUTODOC recommends:

- All work should be done with the engine stopped.

## REPLACEMENT: WING MIRROR – MERCEDES W201. USE THE FOLLOWING PROCEDURE:

**1** Open the car door.



**2** Lower the window glass.

**3** Use a fender protection cover to prevent damaging paintwork and plastic parts of the car.

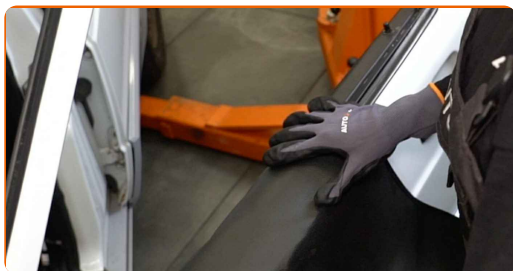

**4** Unscrew the interior trim that hides the wing mirror fasteners. Use a Phillips screwdriver.

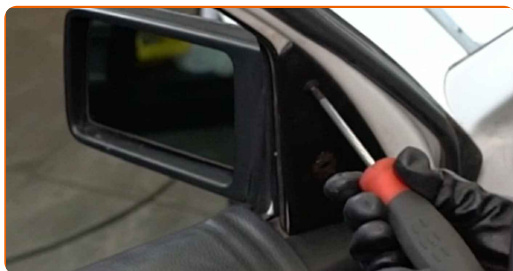

**5** Remove the trim cover that hides the wing mirror fasteners.



**6** Unscrew the wing mirror fasteners. Use a Phillips screwdriver.



**7** Remove the fastening bolts.

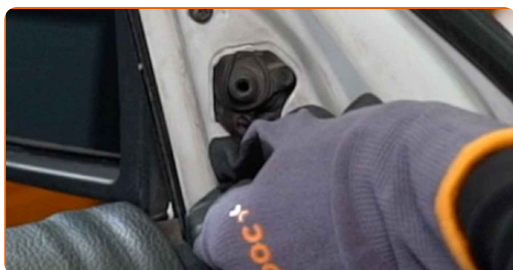

**8** Remove the wing mirror.



**9** Install the new wing mirror.

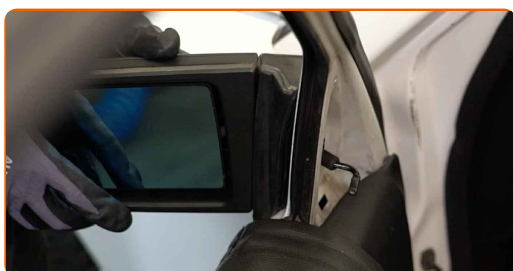

**10** Install the fastening bolts.

**11** Screw in the wing mirror fasteners. Use a Phillips screwdriver.



**12** Install the wing mirror trim cover.

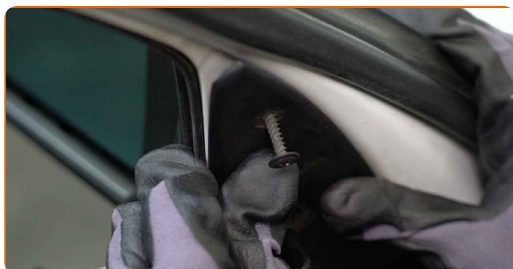

**13** Screw in the interior trim that hides the wing mirror fasteners. Use a Phillips screwdriver.



**14** Remove the fender protection cover.



**15**

Close the car door.



**16**

Adjust the mirror glass.



**WELL DONE!** 

**VIEW MORE TUTORIALS**

# AUTODOC – TOP QUALITY AND AFFORDABLE CAR PARTS ONLINE

**AUTODOC MOBILE APP: GREAT DEALS AND CONVENIENT SHOPPING**



**+ AUTODOC**

GET IT ON  **Google Play**

 **Download on the App Store**

**Download**

**A GREAT SELECTION OF SPARE PARTS FOR YOUR CAR**

**BUY SPARE PARTS FOR MERCEDES**

**WING MIRROR: A WIDE SELECTION**



**CHOOSE CAR PARTS FOR MERCEDES W201**

**WING MIRROR FOR MERCEDES: BUY NOW**

**WING MIRROR FOR MERCEDES W201: THE BEST DEALS & OFFERS**

### **DISCLAIMER:**

The document contains only general recommendations that may be useful for you when you perform repair or replacement work. AUTODOC shall not be liable for any loss, injury, damage of property occurring in the repair or replacement process due to incorrect use or misinterpretation of the provided information.

AUTODOC shall not be liable for any possible mistakes and uncertainties in this guide. The information provided is for information purposes only and cannot replace advice from specialists.

AUTODOC shall not be liable for incorrect or hazardous usage of equipment, tools and car parts. AUTODOC strongly recommends to be careful and observe the safety rules when performing repair or replacement works. Remember: usage of low quality auto parts does not guarantee you the appropriate level of road safety.

© Copyright 2023 – All the contents of this website, in particular texts, photographs and graphics, are protected by copyright. All rights, including reproduction, publication, editing and translation rights, are reserved by AUTODOC SE.