

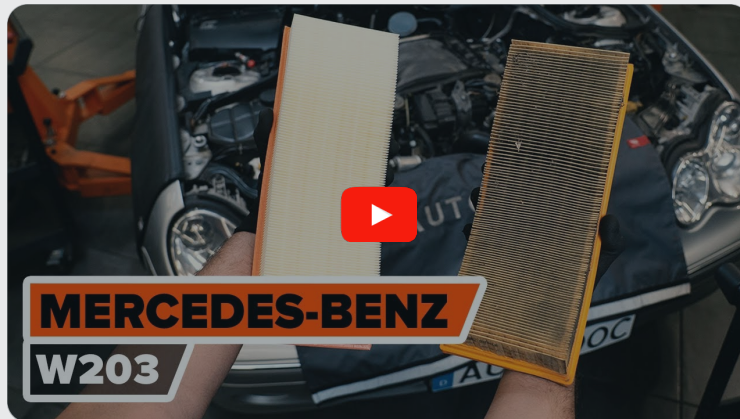

How to change air filter  
on **MERCEDES-BENZ E-  
Class T-modell (S211)** –  
replacement guide

### SIMILAR VIDEO TUTORIAL



This video shows the replacement procedure of a similar car part on another vehicle

#### Important!

This replacement procedure can be used for:

MERCEDES-BENZ E-Class T-modell (S211) E 240 T (211.261), MERCEDES-BENZ E-Class T-modell (S211) E 320 T (211.265), MERCEDES-BENZ E-Class T-modell (S211) E 240 T 4-matic (211.280), MERCEDES-BENZ E-Class T-modell (S211) E 320 T 4-matic (211.282), MERCEDES-BENZ E-Class T-modell (S211) E 55 T AMG Kompressor (211.276), MERCEDES-BENZ E-Class T-modell (S211) E 500 T (211.270), MERCEDES-BENZ E-Class T-modell (S211) E 280 T (211.254), MERCEDES-BENZ E-Class T-modell (S211) E 350 T (211.256), MERCEDES-BENZ E-Class T-modell (S211) E 280 T 4-matic (211.292), MERCEDES-BENZ E-Class T-modell (S211) E 350 T 4-matic (211.287), MERCEDES-BENZ E-Class T-modell (S211) E 500 T (211.272), MERCEDES-BENZ E-Class T-modell (S211) E 500 T 4-matic (211.290), MERCEDES-BENZ E-Class T-modell (S211) 350 CGI 3.5 (211.257), MERCEDES-BENZ E-Class T-modell (S211) 3.5 4-matic, MERCEDES-BENZ E-Class T-modell (S211) E 230 T (211.252), (+ 1)

The steps may slightly vary depending on the car design.

Please note that this tutorial was created based on the replacement procedure for this car part on a car with a similar design.

This tutorial was created based on the replacement procedure for a similar car part on: MERCEDES-BENZ C-Class Saloon (W203) C 240 (203.061)

REPLACEMENT: AIR FILTER – MERCEDES-BENZ E-CLASS T-MODELL (S211). TOOLS YOU MIGHT NEED:

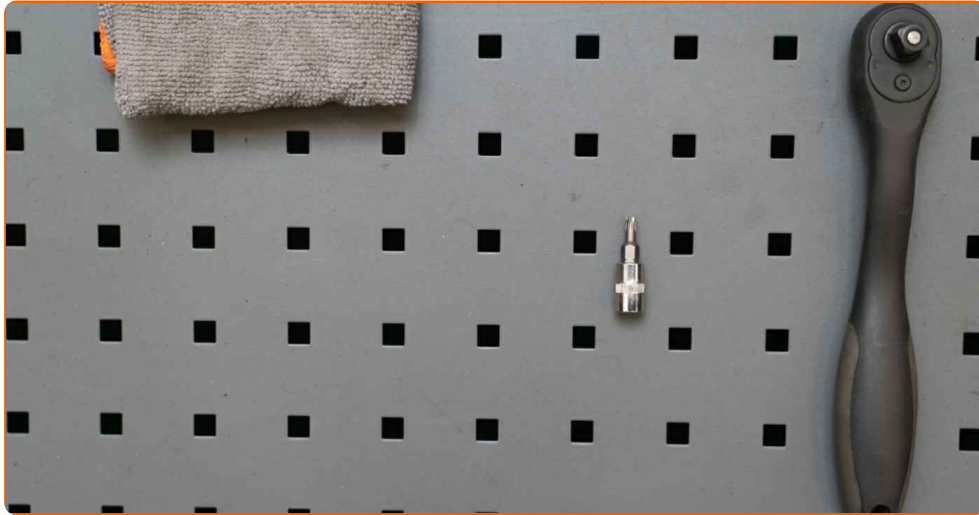

- Torx bit T20
- Ratchet wrench
- Microfibre towel
- Fender cover

**Buy tools**

Replacement: air filter – MERCEDES-BENZ E-Class T-modell (S211). AUTODOC experts recommend:

- Follow the terms, recommendations and requirements of the part operation provided by the manufacturer.
- Please note: all work on the car – MERCEDES-BENZ E-Class T-modell (S211) – should be done with the engine switched off.

## CARRY OUT REPLACEMENT IN THE FOLLOWING ORDER:

**1** Open the bonnet.

**2** Use a fender protection cover to prevent damaging paintwork and plastic parts of the car.

**3** Remove the engine cover.



### AUTODOC recommends:

- Replacement: air filter – MERCEDES-BENZ E-Class T-modell (S211). Do not use excessive force when removing the part as this may damage it.

4 Remove the air intake hoses.

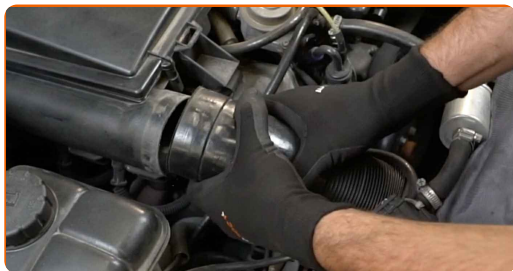

5 Clean the air filter cover and housing.

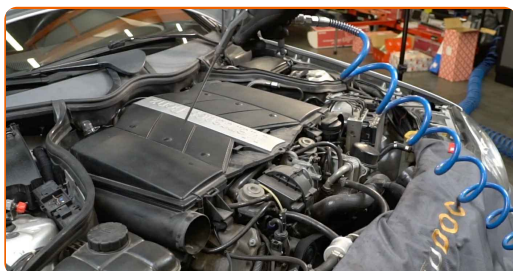

6 Remove the air filter housing.



**AUTODOC recommends:**

- Replacement: air filter – MERCEDES-BENZ E-Class T-modell (S211). Do not use excessive force when removing the part as this may damage it.

7 Cover the throttle body with a microfibre towel to prevent dust and dirt from getting into the system.

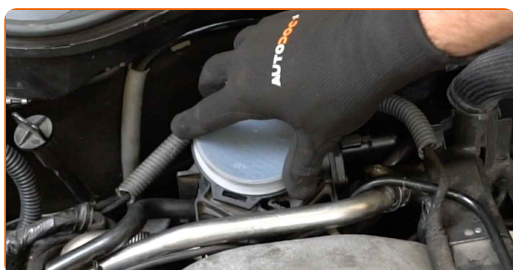

**8** Clean the air filter cover and housing.



**9** Unscrew the fasteners of the air filter covers. Use Torx T20. Use a ratchet wrench.

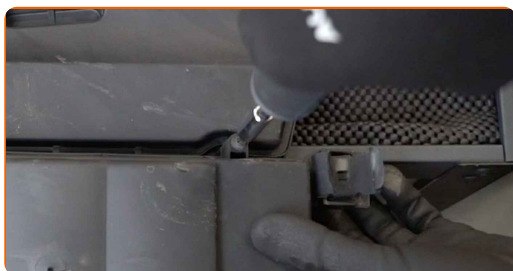

**10** Remove the air filter covers along with filter elements.

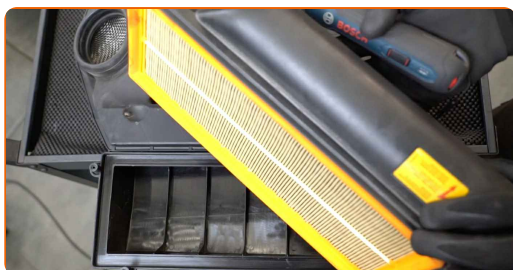

**11** Remove the old filter elements.

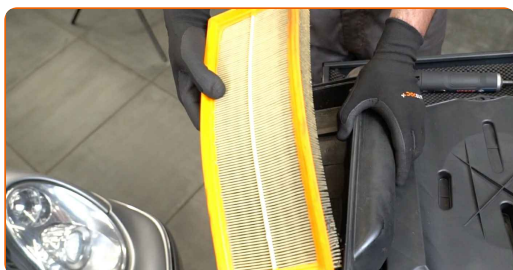

**12** Clean the air filter cover and housing.



**13**

Install new filter elements. Make sure that the edges of the filters fit tightly into the housing.



**AUTODOC recommends:**

- Replacement: air filter – MERCEDES-BENZ E-Class T-modell (S211). Be sure to position the filtering element correctly. Avoid misalignment.
- Take care to only use quality filters.
- During installation, make sure to prevent dust and dirt from getting into the air filter housing.

**14**

Reinstall the air filter covers along with the filter elements.



**15**

Screw in the fasteners of the air filter covers. Use Torx T20. Use a ratchet wrench.





**16** Remove the microfibre towel from the throttle body.



**17** Install the air filter housing.



**AUTODOC recommends:**

- Replacement: air filter – MERCEDES-BENZ E-Class T-modell (S211). To avoid damaging the part during installation, do not use excessive force.

**18** Install the engine cover and secure it.



## AUTODOC recommends:

- Make sure the engine cover is properly seated. It should not be displaced with respect to the guiding fasteners and the throttle body air intake hose.
- Replacement: air filter – MERCEDES-BENZ E-Class T-modell (S211). Do not use excessive force during installation. This may damage the part.

19

Reinstall the air intake hoses.

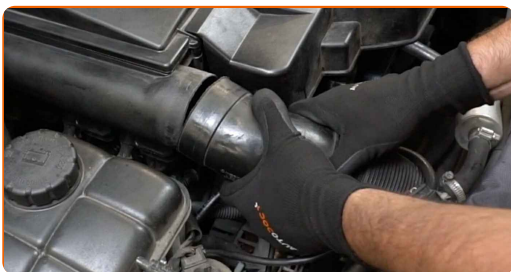

20

Remove the fender protection cover.

21

Close the hood.

**WELL DONE!** [VIEW MORE TUTORIALS](#)

# AUTODOC – TOP QUALITY AND AFFORDABLE CAR PARTS ONLINE

**AUTODOC MOBILE APP: GREAT DEALS AND CONVENIENT SHOPPING**



**+ AUTODOC**

GET IT ON  
**Google Play**

 Download on the  
**App Store**

**Download**

**A GREAT SELECTION OF SPARE PARTS FOR YOUR CAR**

**AIR FILTER: A WIDE SELECTION**

## **DISCLAIMER:**

The document contains only general recommendations that may be useful for you when you perform repair or replacement work. AUTODOC shall not be liable for any loss, injury, damage of property occurring in the repair or replacement process due to incorrect use or misinterpretation of the provided information.

AUTODOC shall not be liable for any possible mistakes and uncertainties in this guide. The information provided is for information purposes only and cannot replace advice from specialists.

AUTODOC shall not be liable for incorrect or hazardous usage of equipment, tools and car parts. AUTODOC strongly recommends to be careful and observe the safety rules when performing repair or replacement works. Remember: usage of low quality auto parts does not guarantee you the appropriate level of road safety.

© Copyright 2023 – All the contents of this website, in particular texts, photographs and graphics, are protected by copyright. All rights, including reproduction, publication, editing and translation rights, are reserved by AUTODOC SE.