



How to change rear  
brake pads on  
**MERCEDES-BENZ CLK**  
**Convertible (A209) –**  
replacement guide

### SIMILAR VIDEO TUTORIAL



This video shows the replacement procedure of a similar car part on another vehicle

### Important!

This replacement procedure can be used for:

MERCEDES-BENZ CLK Convertible (A209) CLK 200 Kompressor (209.442),  
 MERCEDES-BENZ CLK Convertible (A209) CLK 240 (209.461), MERCEDES-BENZ CLK  
 Convertible (A209) CLK 320 (209.465), MERCEDES-BENZ CLK Convertible (A209) CLK  
 350 (209.456), MERCEDES-BENZ CLK Convertible (A209) CLK 280 (209.454),  
 MERCEDES-BENZ CLK Convertible (A209) CLK 320 CDI (209.420), MERCEDES-BENZ  
 CLK Convertible (A209) CLK 200 Kompressor (209.441)

The steps may slightly vary depending on the car design.

This tutorial was created based on the replacement procedure for a similar car part  
 on: MERCEDES-BENZ C-Class Saloon (W203) C 240 (203.061)

REPLACEMENT: BRAKE PADS – MERCEDES-BENZ CLK CONVERTIBLE (A209). LIST OF THE TOOLS YOU'LL NEED:

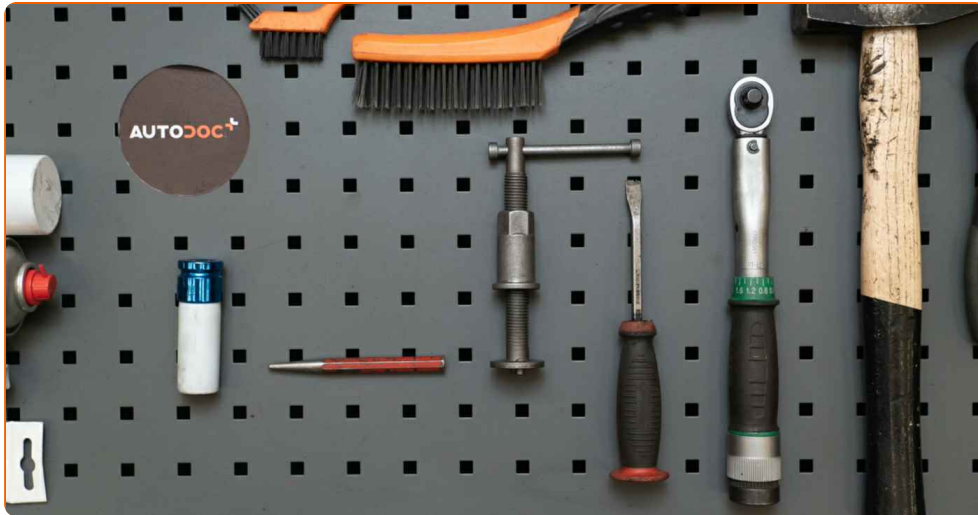

- Wire brush
- Nylon cleaning brush
- All-purpose cleaning spray
- Brake cleaner
- Anti-squeal paste
- Copper grease
- Torque wrench
- Wheel impact socket #17
- Hammer
- Pin punch
- Crow bar
- Wheel chock

**Buy tools**

Replacement: brake pads – MERCEDES-BENZ CLK Convertible (A209).  
AUTODOC experts recommend:

- Perform the replacement of brake pads in complete set for each axis. This provides effective braking.
- The replacement procedure is identical for all brake pads on the same axle.
- All work should be done with the engine stopped.

**CARRY OUT REPLACEMENT IN THE FOLLOWING ORDER:**

**1** Open the bonnet. Unscrew the brake fluid reservoir cap.

**2** Secure the wheels with chocks.

**3** Loosen the wheel mounting bolts. Use wheel impact socket #17.



**4** Raise the rear of the car and secure on supports.

**5** Unscrew the wheel bolts.



**AUTODOC recommends:**

- Important! Hold the wheel while unscrewing the fastening bolts. MERCEDES-BENZ CLK Convertible (A209)

**6**

Remove the wheel.



**7**

Clean the brake pads fasteners. Use a wire brush. Use all-purpose cleaning spray.

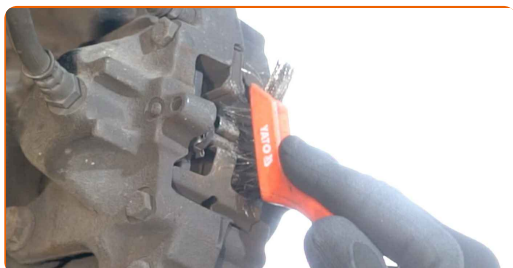

**8**

Remove the brake pad retaining pin. Use a pin punch. Use a hammer.



**9**

Remove the retaining spring of the brake pads.

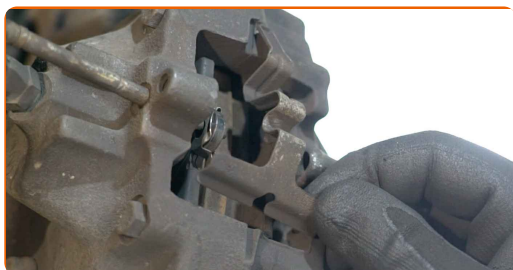

**10**

Spread the brake pads. Use a crowbar.



**11**

Remove the brake pads.



**Replacement: brake pads – MERCEDES-BENZ CLK Convertible (A209). Tip:**

- Measure the brake disc thickness. Upon reaching the wear limit the part must be replaced.

**12**

Treat the brake caliper piston. Use a nylon cleaning brush. Use a brake cleaner.

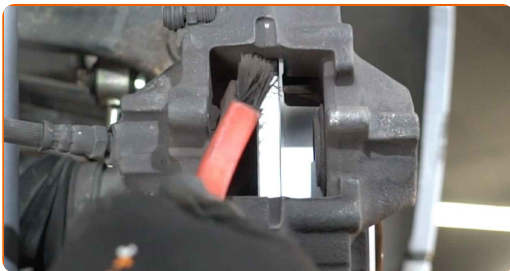

**AUTODOC recommends:**

- Replacement: brake pads – MERCEDES-BENZ CLK Convertible (A209). After applying the spray, wait a few minutes.

**13** Press in the brake caliper piston. Use a crowbar (2 pieces).



**14** Treat the brake pads in the area where their surface comes into contact with the brake caliper bracket. Use anti-squeal paste.

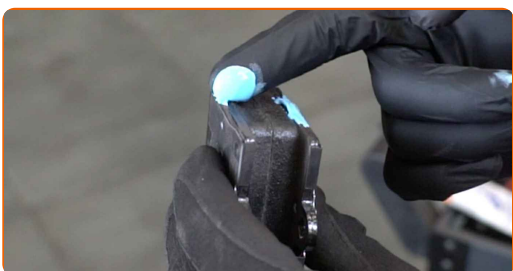

Replacement: brake pads – MERCEDES-BENZ CLK Convertible (A209).  
AUTODOC recommends:

- Make sure the disc surface is clean before installing the pads.

**15** Install new brake pads.

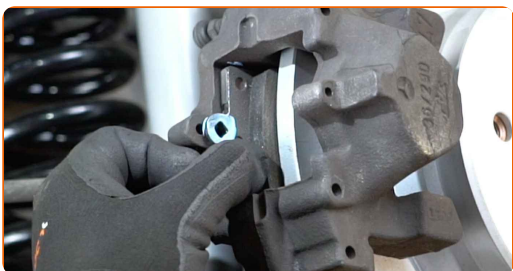

AUTODOC recommends:

- Make sure the pads are installed with linings facing the disc.



**16** Install the retaining spring of the brake pads.

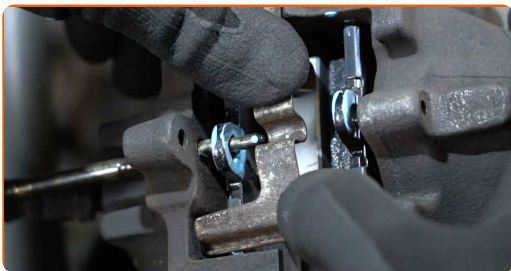

**17** Install the brake pad retaining pin. Use a pin punch. Use a hammer.

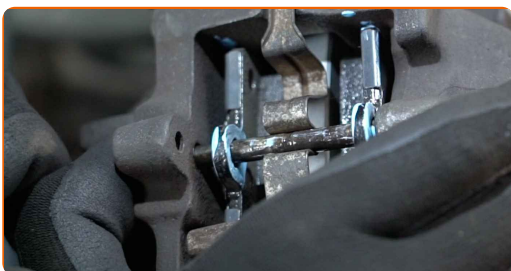

**18** Treat the surface where the brake disc contacts the wheel rim. Use copper grease.

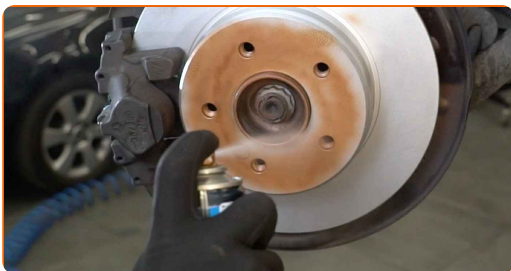

**19** Clean the brake disk surface. Use a brake cleaner.



Replacement: brake pads – MERCEDES-BENZ CLK Convertible (A209).  
Professionals recommend:

- After applying the spray, wait a few minutes.



**20** Install the wheel.



**AUTODOC recommends:**

- Important! Hold the wheel while screwing in the fastening bolts. MERCEDES-BENZ CLK Convertible (A209)

**21** Screw in the wheel bolts. Use wheel impact socket #17.



**22** Lower the car and working in a cross order, tighten the wheel bolts. Use wheel impact socket #17. Use a torque wrench. Tighten it to 110 nm torque.



**23** Remove the jacks and chocks.

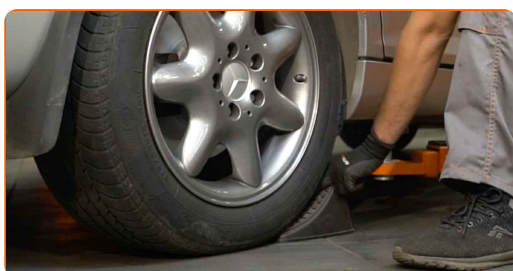

Replacement: brake pads – MERCEDES-BENZ CLK Convertible (A209). Tip from AUTODOC:

- Check the brake fluid level in the expansion tank and refill if necessary.

24

Tighten the brake fluid reservoir cap. Close the hood.

AUTODOC recommends:

- MERCEDES-BENZ CLK Convertible (A209) – Without starting the engine, press the brake pedal several times until it feels firm.
- Slow down smoothly for first 150-200 km after the brake pads replacement. Avoid unnecessary and sharp braking to a stop.

**WELL DONE!** 

[VIEW MORE TUTORIALS](#)

# AUTODOC – TOP QUALITY AND AFFORDABLE CAR PARTS ONLINE

**AUTODOC MOBILE APP: GREAT DEALS AND CONVENIENT SHOPPING**



**+ AUTODOC**

GET IT ON  
**Google Play**

Download on the  
**App Store**

**Download**

**A GREAT SELECTION OF SPARE PARTS FOR YOUR CAR**

**BRAKE PADS: A WIDE SELECTION**

## **DISCLAIMER:**

The document contains only general recommendations that may be useful for you when you perform repair or replacement work. AUTODOC shall not be liable for any loss, injury, damage of property occurring in the repair or replacement process due to incorrect use or misinterpretation of the provided information.

AUTODOC shall not be liable for any possible mistakes and uncertainties in this guide. The information provided is for information purposes only and cannot replace advice from specialists.

AUTODOC shall not be liable for incorrect or hazardous usage of equipment, tools and car parts. AUTODOC strongly recommends to be careful and observe the safety rules when performing repair or replacement works. Remember: usage of low quality auto parts does not guarantee you the appropriate level of road safety.

© Copyright 2022 – All the contents of this website, in particular texts, photographs and graphics, are protected by copyright. All rights, including reproduction, publication, editing and translation rights, are reserved by AUTODOC GmbH.