



How to change rear
brake pad wear sensor on
Mercedes ML W163 –
replacement guide

VIDEO TUTORIAL



Important!

This replacement procedure can be used for:

MERCEDES-BENZ M-Class (W163) ML 320 (163.154), MERCEDES-BENZ M-Class (W163) ML 430 (163.172), MERCEDES-BENZ M-Class (W163) ML 55 AMG (163.174), MERCEDES-BENZ M-Class (W163) ML 400 CDI (163.128), MERCEDES-BENZ M-Class (W163) ML 500 (163.175)

The steps may slightly vary depending on the car design.

REPLACEMENT: BRAKE PAD WEAR SENSOR –
MERCEDES ML W163. TOOLS YOU MIGHT NEED:



- Wire brush
- Nylon cleaning brush
- Brake cleaner
- Anti-squeal paste
- Copper grease
- Torque wrench
- Wheel impact socket #17
- Pin punch
- Hammer
- Rubber mallet
- Brake caliper wind back tool
- Crow bar
- Wheel chock

BUY TOOLS

Replacement: brake pad wear sensor – Mercedes ML W163. Tip:

- The replacement procedure is identical for both brake pad wear sensors on the same axle.
- Please note: all work on the car – Mercedes ML W163 – should be done with the engine switched off.

CARRY OUT REPLACEMENT IN THE FOLLOWING ORDER:

1

Open the bonnet. Unscrew the brake fluid reservoir cap.



2

Secure the wheels with chocks.

3

Loosen the wheel mounting bolts. Use wheel impact socket #17.

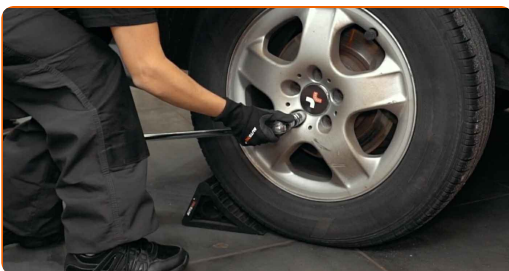

4

Raise the rear of the car and secure on supports.

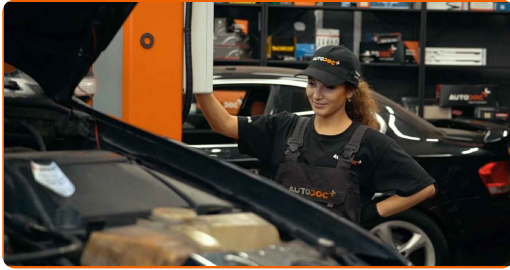

5

Unscrew the wheel bolts.



AUTODOC recommends:

- Warning! To avoid injury, hold the wheel while unscrewing the fastening bolts.
Mercedes ML W163

6

Remove the wheel.



7

Detach the connector of the brake pad wear sensor.



Please note!

- Some cars are not equipped with the brake pad wear sensor.

8

Clean the brake caliper surface. Use a wire brush. Use a brake cleaner.

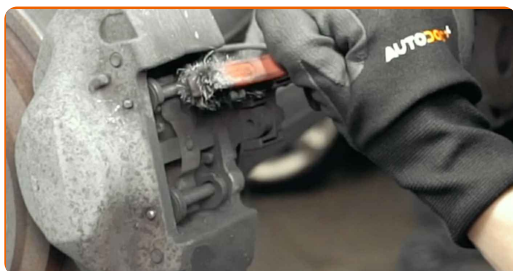

AUTODOC recommends:

- Replacement: brake pad wear sensor – Mercedes ML W163. After applying the spray, wait a few minutes.

9

Remove the brake pads retaining clips. Use a pin punch. Use a hammer. Use a crowbar.

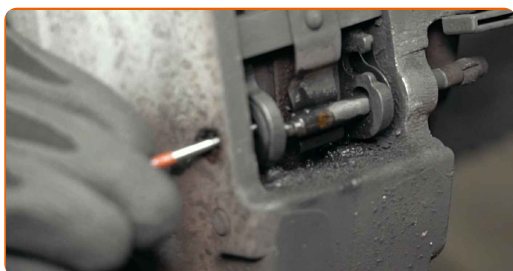

10

Remove the brake pads. Use a crowbar.

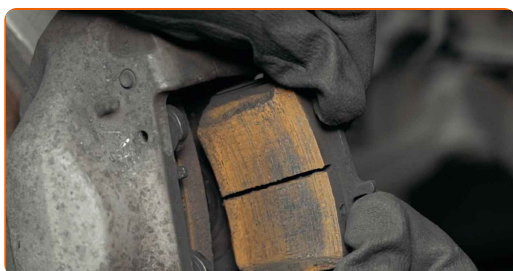

11

Remove the brake pad wear sensor from the brake pad.

12

Treat the brake caliper piston. Use a nylon cleaning brush. Use a brake cleaner.



Replacement: brake pad wear sensor – Mercedes ML W163. Tip from AUTODOC experts:

- After applying the spray, wait a few minutes.

13

Press in the brake caliper piston. Use brake caliper wind back tool. Use a crowbar.

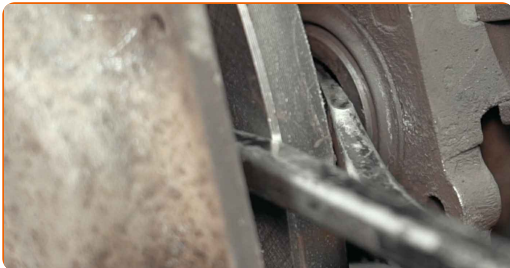

14

Clean the brake caliper surface. Use a wire brush. Use a brake cleaner.

AUTODOC recommends:

- Replacement: brake pad wear sensor – Mercedes ML W163. After applying the spray, wait a few minutes.

- 15** Treat the brake pads in the area where their surface comes into contact with the brake caliper bracket. Use anti-squeal paste.



AUTODOC recommends:

- Make sure the disc surface is clean before installing the pads.

- 16** Install the brake pads.



- 17** Install the brake pads retaining clips. Use a pin punch. Use a rubber mallet.



- 18** Install the wear sensor on the brake pads.

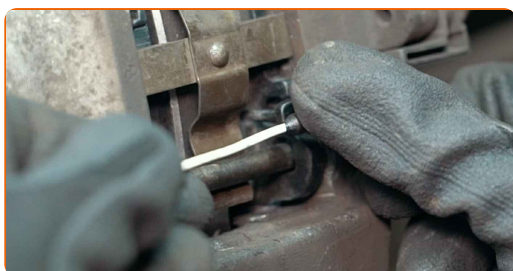

19 Attach the connector of the brake pad wear sensor.



20 Clean the wheel rim mounting seat. Use a wire brush.

21 Treat the surface where the brake disc contacts the wheel rim. Use copper grease.

22 Clean the brake disk surface. Use a brake cleaner.

AUTODOC recommends:

- Replacement: brake pad wear sensor – Mercedes ML W163. After applying the spray, wait a few minutes.

23 Install the wheel.



AUTODOC recommends:

- Warning! To avoid injury, hold the wheel while screwing in the fastening bolts on the car. Mercedes ML W163

24 Screw in the wheel bolts. Use wheel impact socket #17.



25 Lower the car and working in a cross order, tighten the wheel bolts. Use wheel impact socket #17. Use a torque wrench. Tighten it to 150 Nm torque.



26 Remove the jacks and chocks.



Replacement: brake pad wear sensor – Mercedes ML W163. AUTODOC recommends:

- Check the brake fluid level in the expansion tank and refill if necessary.
- Without starting the engine, press the brake pedal several times until you feel significant resistance.

27

Tighten the brake fluid reservoir cap. Close the hood.



WELL DONE! 

[VIEW MORE TUTORIALS](#)

AUTODOC – TOP QUALITY AND AFFORDABLE CAR PARTS ONLINE

AUTODOC MOBILE APP: GREAT DEALS AND CONVENIENT SHOPPING



+ AUTODOC

GET IT ON  **Google Play**

 **Download on the App Store**

Download

A GREAT SELECTION OF SPARE PARTS FOR YOUR CAR

BUY SPARE PARTS FOR MERCEDES

BRAKE PAD WEAR SENSOR: A WIDE SELECTION

CHOOSE CAR PARTS FOR MERCEDES ML W163

BRAKE PAD WEAR SENSOR FOR MERCEDES: BUY NOW

**BRAKE PAD WEAR SENSOR FOR MERCEDES ML W163: THE
BEST DEALS & OFFERS**

DISCLAIMER:

The document contains only general recommendations that may be useful for you when you perform repair or replacement work. AUTODOC shall not be liable for any loss, injury, damage of property occurring in the repair or replacement process due to incorrect use or misinterpretation of the provided information.

AUTODOC shall not be liable for any possible mistakes and uncertainties in this guide. The information provided is for information purposes only and cannot replace advice from specialists.

AUTODOC shall not be liable for incorrect or hazardous usage of equipment, tools and car parts. AUTODOC strongly recommends to be careful and observe the safety rules when performing repair or replacement works. Remember: usage of low quality auto parts does not guarantee you the appropriate level of road safety.

© Copyright 2022 – All the contents of this website, in particular texts, photographs and graphics, are protected by copyright. All rights, including reproduction, publication, editing and translation rights, are reserved by AUTODOC GmbH.