



How to change pollen
filter on **Honda Jazz GD** –
replacement guide

VIDEO TUTORIAL



Important!

This replacement procedure can be used for:

HONDA Jazz II Hatchback (GD_, GE3, GE2) 1.3 iDSi, HONDA Jazz II Hatchback (GD_, GE3, GE2) 1.4, HONDA Jazz II Hatchback (GD_, GE3, GE2) 1.3 (GD1), HONDA Jazz II Hatchback (GD_, GE3, GE2) 1.5, HONDA Jazz Saloon (GD_) 1.3 (GD6), HONDA Jazz Saloon (GD_) 1.5 i-DSI (GD8), HONDA Jazz II Hatchback (GD_, GE3, GE2) 1.4 LX Flex, HONDA Jazz II Hatchback (GD_, GE3, GE2) 1.4 iDSI (GE3), HONDA Jazz II Hatchback (GD_, GE3, GE2) 1.3 iDSi 4WD, HONDA Jazz Saloon (GD_) 1.5 i-DSI 4WD (GD9)

The steps may slightly vary depending on the car design.

Replacement: pollen filter – Honda Jazz GD. Tip from AUTODOC:

- Replace the cabin filter at least once every six months, in early spring and autumn seasons.
- Follow the terms, recommendations and requirements of the part operation provided by the manufacturer.
- If the air flow into the cabin has sharply reduced, replace the filter before a scheduled maintenance.
- Please note: all work on the car – Honda Jazz GD – should be done with the engine switched off.

CARRY OUT REPLACEMENT IN THE FOLLOWING ORDER:

1 Open the glove box.



2 Press the retainers.

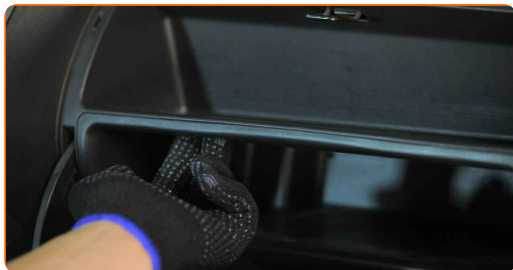

3 Take the plastic shelf out of the glove box.

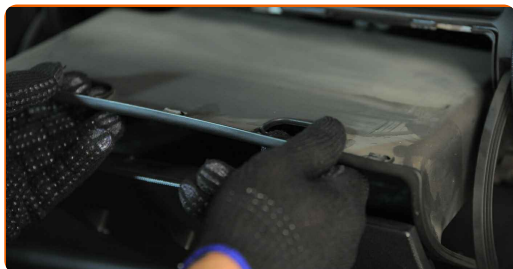

4 Release the cabin filter cover clips.



5 Remove the cabin filter housing.



6 Remove the cabin filter.



Replacement: pollen filter – Honda Jazz GD. AUTODOC experts recommend:

- Do not attempt to clean and reuse the filter - it will affect the quality of air cleaning inside the car.

7

Install the cabin filter to its mounting seat. Make sure that the filter edge fits tight to the housing.



Replacement: pollen filter – Honda Jazz GD. Tip:

- Follow the air flow direction arrow on the filter.
- Check out the correct location of the filter element. Do not skew.
- Attention! Use quality filters – Honda Jazz GD.

8

Install the cabin filter housing. Make sure you hear a click indicating that it is locked in place.



9

Install the plastic shelf inside the glove box. Make sure you hear a click indicating that it is locked in place.



10 Close the glove box.



11 Switch on the ignition.



12 Switch on the air conditioning system. This is necessary in order to make sure that the component operates properly.

13 Switch off the ignition.

WELL DONE! 

VIEW MORE TUTORIALS

AUTODOC – TOP QUALITY AND AFFORDABLE CAR PARTS ONLINE

AUTODOC MOBILE APP: GREAT DEALS AND CONVENIENT SHOPPING



+ AUTODOC

GET IT ON  **Google Play**

 **Download on the App Store**

Download

A GREAT SELECTION OF SPARE PARTS FOR YOUR CAR

BUY SPARE PARTS FOR HONDA

POLLEN FILTER: A WIDE SELECTION

CHOOSE CAR PARTS FOR HONDA JAZZ GD

POLLEN FILTER FOR HONDA: BUY NOW

POLLEN FILTER FOR HONDA JAZZ GD: THE BEST DEALS & OFFERS

DISCLAIMER:

The document contains only general recommendations that may be useful for you when you perform repair or replacement work. AUTODOC shall not be liable for any loss, injury, damage of property occurring in the repair or replacement process due to incorrect use or misinterpretation of the provided information.

AUTODOC shall not be liable for any possible mistakes and uncertainties in this guide. The information provided is for information purposes only and cannot replace advice from specialists.

AUTODOC shall not be liable for incorrect or hazardous usage of equipment, tools and car parts. AUTODOC strongly recommends to be careful and observe the safety rules when performing repair or replacement works. Remember: usage of low quality auto parts does not guarantee you the appropriate level of road safety.

© Copyright 2023 – All the contents of this website, in particular texts, photographs and graphics, are protected by copyright. All rights, including reproduction, publication, editing and translation rights, are reserved by AUTODOC SE.