



How to change an exterior front door handle on the **FORD Transit Mk6 Minibus (V347, V348)** – replacement guide

SIMILAR VIDEO TUTORIAL



This video shows the replacement procedure of a similar car part on another vehicle

Important!

This replacement procedure can be used for:

FORD TRANSIT Bus 2.2 TDCi, FORD TRANSIT Bus 2.2 TDCi RWD, FORD TRANSIT Bus 2.4 TDCi, FORD TRANSIT Bus 2.4 TDCi 4x4, FORD TRANSIT Bus 3.2 TDCi

The steps may slightly vary depending on the car design.

This tutorial was created based on the replacement procedure for a similar car part on: FORD TRANSIT MK-7 Box 2.2 TDCi

REPLACEMENT: DOOR HANDLE – FORD TRANSIT MK6
MINIBUS (V347, V348). TOOLS YOU'LL NEED:



- Electronic spray
- Torque wrench
- 10 mm socket
- Ratchet wrench
- Phillips screwdriver
- Plastic trim removal tool

[Buy tools](#)

Replacement: door handle – FORD Transit Mk6 Minibus (V347, V348).
 AUTODOC recommends:

- The replacement procedure is identical for the left and right front door handles.
- All the work should be carried out with the ignition switched off.

REPLACEMENT: DOOR HANDLE – FORD TRANSIT MK6 MINIBUS (V347, V348). RECOMMENDED SEQUENCE OF STEPS:

1 Open the car door.



2 Unscrew the fastener of the exterior door handle. Use a 10 mm socket. Use a ratchet wrench.



3 Remove the exterior door handle.



4 Transfer the lock rod to a new exterior door handle.

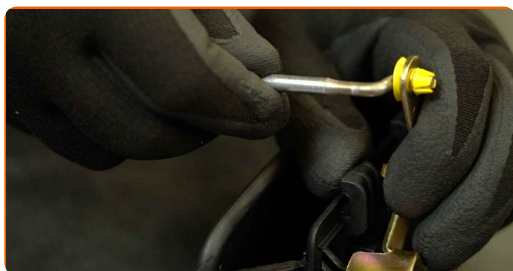

5 Install the new exterior door handle.

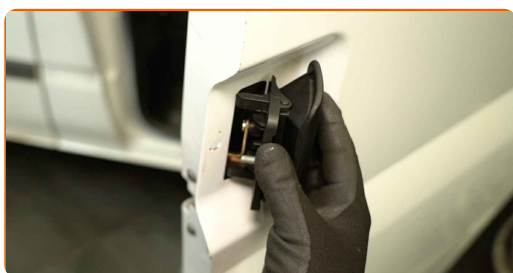

6 Tighten the door handle fastener. Use a 10 mm socket. Use a torque wrench. Tightening torque: 10 N·m.

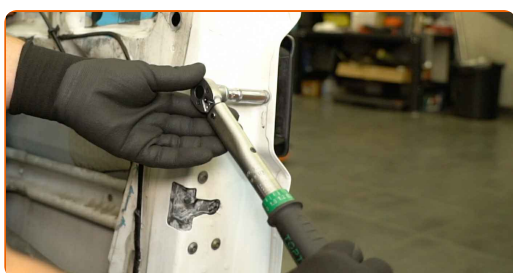

7 Close the car door.

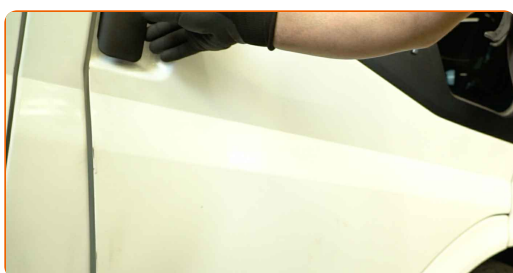

8 Check that the new component is working.

WELL DONE! 

VIEW MORE TUTORIALS

AUTODOC – TOP QUALITY AND AFFORDABLE CAR PARTS ONLINE

AUTODOC MOBILE APP: GREAT DEALS AND CONVENIENT SHOPPING



+ AUTODOC

GET IT ON
Google Play

 Download on the
App Store

Download

A GREAT SELECTION OF SPARE PARTS FOR YOUR CAR

DOOR HANDLE: A WIDE SELECTION

DISCLAIMER:

The document contains only general recommendations that may be useful for you when you perform repair or replacement work. AUTODOC shall not be liable for any loss, injury, damage of property occurring in the repair or replacement process due to incorrect use or misinterpretation of the provided information.

AUTODOC shall not be liable for any possible mistakes and uncertainties in this guide. The information provided is for information purposes only and cannot replace advice from specialists.

AUTODOC shall not be liable for incorrect or hazardous usage of equipment, tools and car parts. AUTODOC strongly recommends to be careful and observe the safety rules when performing repair or replacement works. Remember: usage of low quality auto parts does not guarantee you the appropriate level of road safety.

© Copyright 2024 – All the contents of this website, in particular texts, photographs and graphics, are protected by copyright. All rights, including reproduction, publication, editing and translation rights, are reserved by AUTODOC SE.