



How to change pollen  
filter on **FORD Fiesta**  
**Mk5 Saloon (JAS, JBS)** –  
replacement guide

## SIMILAR VIDEO TUTORIAL



This video shows the replacement procedure of a similar car part on another vehicle

### Important!

This replacement procedure can be used for:

FORD Fiesta Mk5 Saloon (JAS, JBS) 1.4 TDCi, FORD Fiesta Mk5 Saloon (JAS, JBS) 1.0, FORD Fiesta Mk5 Saloon (JAS, JBS) 1.0 Flex, FORD Fiesta Mk5 Saloon (JAS, JBS) 1.6 Flex

The steps may slightly vary depending on the car design.

This tutorial was created based on the replacement procedure for a similar car part on: FORD Fiesta Mk5 Hatchback (JH1, JD1, JH3, JD3) 1.4 16V

REPLACEMENT: POLLEN FILTER – FORD FIESTA MK5 SALOON (JAS, JBS). TOOLS YOU MIGHT NEED:

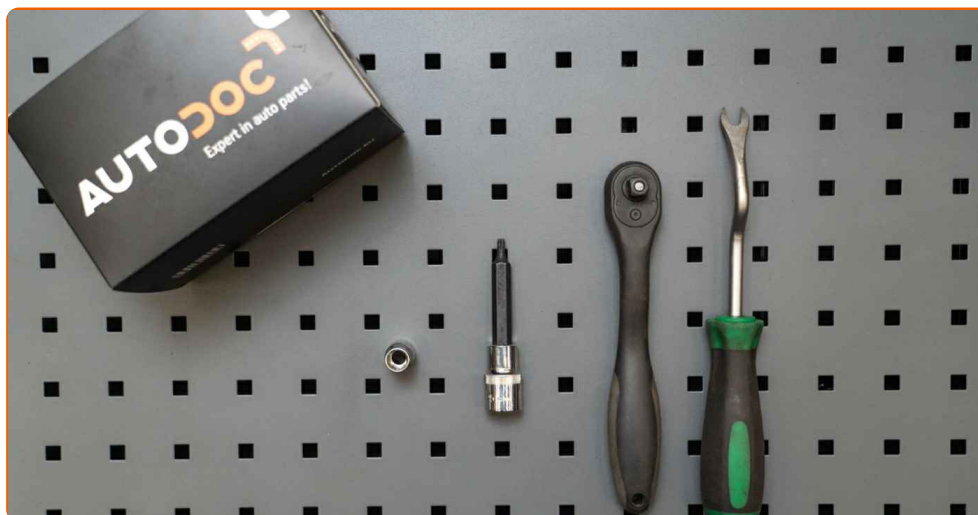

- Drive socket # 10
- Torx bit T20
- Ratchet wrench
- Clip removal tool

**Buy tools**

Replacement: pollen filter – FORD Fiesta Mk5 Saloon (JAS, JBS).  
Professionals recommend:

- Replace the cabin filter at least once every six months, in early spring and autumn seasons.
- Follow the terms, recommendations and requirements of the part operation provided by the manufacturer.
- If the air flow into the cabin has sharply reduced, replace the filter before a scheduled maintenance.
- Warning! Shut down the engine before starting any work – FORD Fiesta Mk5 Saloon (JAS, JBS).

**CARRY OUT REPLACEMENT IN THE FOLLOWING ORDER:**

**1** Unscrew the fastener of the accelerator pedal and move it aside. Use a drive socket #10. Use a ratchet wrench.

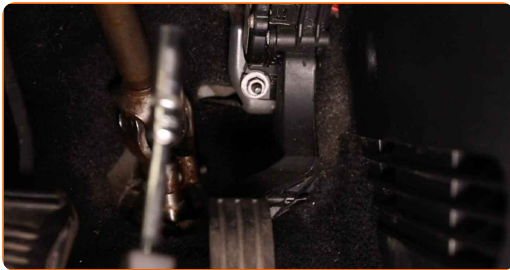

**2** Remove the clips from the plastic side panel. Use a clip removal tool.

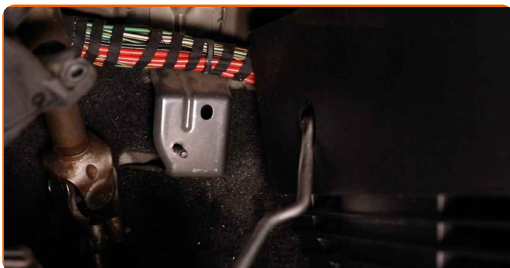

**3** Remove the side plastic cover.

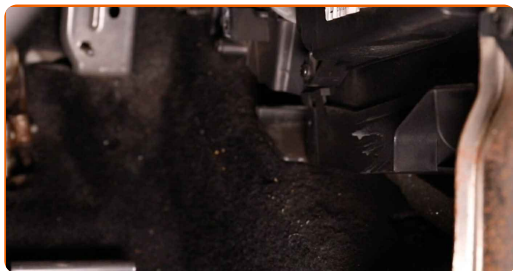

**4** Unscrew the fasteners of the cabin filter housing cover. Use Torx T20. Use a ratchet wrench.



**5** Remove the cabin filter housing cover.

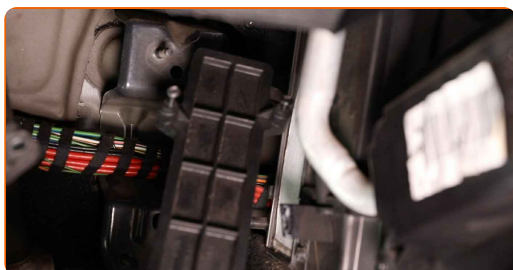

**AUTODOC recommends:**

- Replacement: pollen filter – FORD Fiesta Mk5 Saloon (JAS, JBS). Do not use excessive force when removing the part as this may damage it.

**6** Remove the cabin filter.



Replacement: pollen filter – FORD Fiesta Mk5 Saloon (JAS, JBS). AUTODOC experts recommend:

- Do not attempt to clean and reuse the filter - it will affect the quality of air cleaning inside the car.

7

Install the cabin filter to its mounting seat.



AUTODOC recommends:

- Replacement: pollen filter – FORD Fiesta Mk5 Saloon (JAS, JBS). Be sure to position the filtering element correctly. Avoid misalignment.
- Follow the air flow direction arrow on the filter.
- FORD Fiesta Mk5 Saloon (JAS, JBS) – It's important to only use high-quality filters.

8

Reinstall the cabin filter housing cover.



**AUTODOC recommends:**

- Replacement: pollen filter – FORD Fiesta Mk5 Saloon (JAS, JBS). Do not use excessive force during installation. This may damage the fasteners.

**9**

Screw in the fasteners of the cabin filter housing cover. Use Torx T20. Use a ratchet wrench.

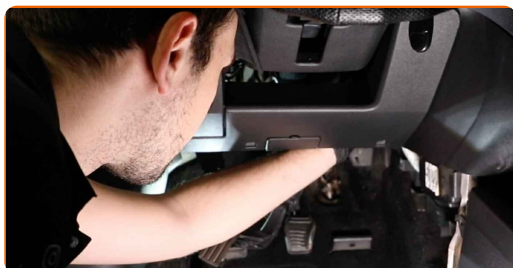

**10**

Install the side plastic panel.

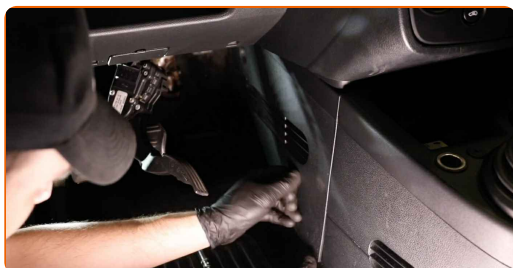

**11**

Reinstall the clips of the plastic side panel.

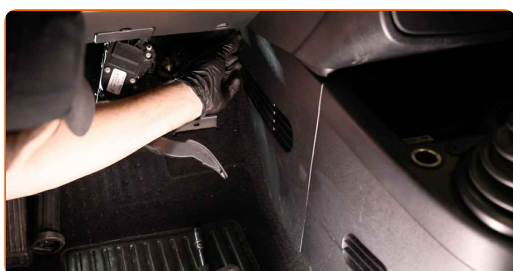

**12**

Return the accelerator pedal to its initial position and screw in its fastener. Use a drive socket #10. Use a ratchet wrench.

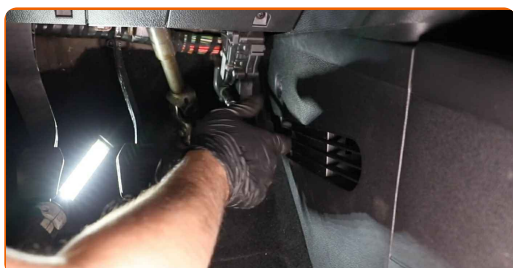

13 Switch on the ignition.

14 Switch on the air conditioning system. This is necessary in order to make sure that the component operates properly.

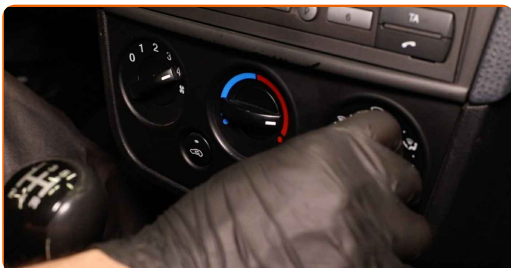

15 Switch off the ignition.

**WELL DONE!** 

[VIEW MORE TUTORIALS](#)



# AUTODOC – TOP QUALITY AND AFFORDABLE CAR PARTS ONLINE

**AUTODOC MOBILE APP: GREAT DEALS AND CONVENIENT SHOPPING**



**+ AUTODOC**

GET IT ON  
**Google Play**

Download on the  
**App Store**

**Download**

**A GREAT SELECTION OF SPARE PARTS FOR YOUR CAR**

**POLLEN FILTER: A WIDE SELECTION**

## **DISCLAIMER:**

The document contains only general recommendations that may be useful for you when you perform repair or replacement work. AUTODOC shall not be liable for any loss, injury, damage of property occurring in the repair or replacement process due to incorrect use or misinterpretation of the provided information.

AUTODOC shall not be liable for any possible mistakes and uncertainties in this guide. The information provided is for information purposes only and cannot replace advice from specialists.

AUTODOC shall not be liable for incorrect or hazardous usage of equipment, tools and car parts. AUTODOC strongly recommends to be careful and observe the safety rules when performing repair or replacement works. Remember: usage of low quality auto parts does not guarantee you the appropriate level of road safety.

© Copyright 2023 – All the contents of this website, in particular texts, photographs and graphics, are protected by copyright. All rights, including reproduction, publication, editing and translation rights, are reserved by AUTODOC SE.