



How to change glass for
wing mirror on **Mercedes**
W124 – replacement
guide

VIDEO TUTORIAL



i Important!

This replacement procedure can be used for:

MERCEDES-BENZ 190 (W201) E 1.8 (201.018), MERCEDES-BENZ 190 (W201) 2.0 (201.022), MERCEDES-BENZ 190 (W201) E 2.0 (201.024), MERCEDES-BENZ 190 (W201) 2.0 (201.023), MERCEDES-BENZ 190 (W201) E 2.0, MERCEDES-BENZ 190 (W201) E 2.3-16, MERCEDES-BENZ 190 (W201) E 2.3-16 (201.034), MERCEDES-BENZ 190 (W201) E 2.3, MERCEDES-BENZ 190 (W201) E 2.3 (201.028), MERCEDES-BENZ 190 (W201) E 2.5-16, MERCEDES-BENZ 190 (W201) E 2.6, MERCEDES-BENZ 190 (W201) D 2.0 (201.122), MERCEDES-BENZ 190 (W201) D 2.5 (201.126), MERCEDES-BENZ 190 (W201) Turbo-D 2.5 (201.128), MERCEDES-BENZ 190 (W201) E Evolution II 2.5, (+ 72)

The steps may slightly vary depending on the car design.

REPLACEMENT: GLASS FOR WING MIRROR –
MERCEDES W124. LIST OF THE TOOLS YOU'LL NEED:



- Dielectric grease
- Plastic trim tool
- Fender cover

BUY TOOLS

Replacement: glass for wing mirror – Mercedes W124. Tip from AUTODOC experts:

- The replacement procedure is identical for the right and left side mirror glass.
- Please note: all work on the car – Mercedes W124 – should be done with the engine switched off.

CARRY OUT REPLACEMENT IN THE FOLLOWING ORDER:

1 Turn the mirror glass all the way inward.



2 Use a fender protection cover to prevent damaging paintwork and plastic parts of the car.

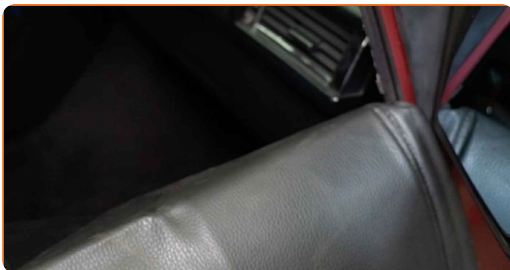

3 Carefully release the mirror glass from its attachment. Use a plastic trim tool.

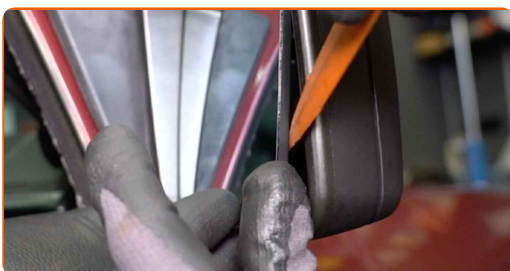

4 Remove the mirror glass.

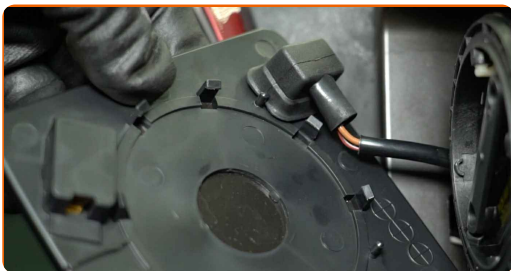

5 Detach the mirror heater connector.

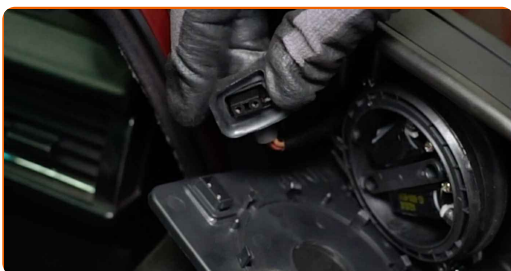

6 Treat the mirror heater connector. Use dielectric grease.

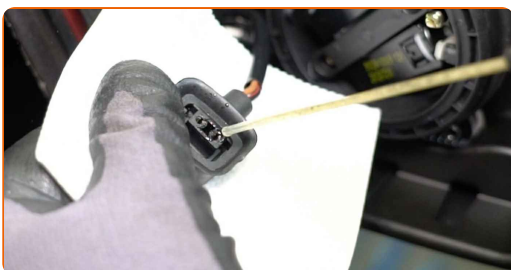

7 Attach the mirror heater connector.

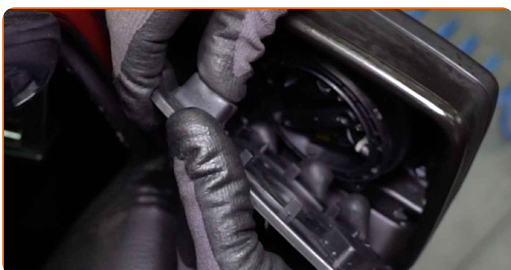

8 Install the new mirror glass.

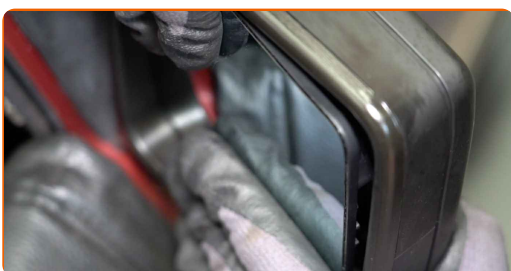

Replacement: glass for wing mirror – Mercedes W124. Tip:

- Make sure you hear a click indicating that it is locked in place.
- When installing, do not use excessive force to avoid damage to the part.
- Make sure the mirror glass is positioned correctly. It should be aligned with the locking tabs on the housing.

9

Adjust the mirror glass.



10

Remove the fender protection cover.

WELL DONE! 

[VIEW MORE TUTORIALS](#)

AUTODOC – TOP QUALITY AND AFFORDABLE CAR PARTS ONLINE

AUTODOC MOBILE APP: GREAT DEALS AND CONVENIENT SHOPPING



+ AUTODOC

GET IT ON
Google Play

Download on the
App Store

Download

A GREAT SELECTION OF SPARE PARTS FOR YOUR CAR

BUY SPARE PARTS FOR MERCEDES

GLASS FOR WING MIRROR: A WIDE SELECTION

CHOOSE CAR PARTS FOR MERCEDES W124

GLASS FOR WING MIRROR FOR MERCEDES: BUY NOW

**GLASS FOR WING MIRROR FOR MERCEDES W124: THE
BEST DEALS & OFFERS**

DISCLAIMER:

The document contains only general recommendations that may be useful for you when you perform repair or replacement work. AUTODOC shall not be liable for any loss, injury, damage of property occurring in the repair or replacement process due to incorrect use or misinterpretation of the provided information.

AUTODOC shall not be liable for any possible mistakes and uncertainties in this guide. The information provided is for information purposes only and cannot replace advice from specialists.

AUTODOC shall not be liable for incorrect or hazardous usage of equipment, tools and car parts. AUTODOC strongly recommends to be careful and observe the safety rules when performing repair or replacement works. Remember: usage of low quality auto parts does not guarantee you the appropriate level of road safety.

© Copyright 2023 – All the contents of this website, in particular texts, photographs and graphics, are protected by copyright. All rights, including reproduction, publication, editing and translation rights, are reserved by AUTODOC SE.