



How to change pollen  
filter on **Honda Civic 8** –  
replacement guide

## VIDEO TUTORIAL



### Important!

This replacement procedure can be used for:

HONDA CR-V III (RE) 2.4 i-VTEC 4WD (RE7), HONDA CR-V IV (RM\_) 2.0, HONDA CR-V IV (RM\_) 2.4 AWD, HONDA CR-V III (RE) 2.4 4WD (RE4), HONDA Accord VII Saloon (CL, CN) 2.4 i 16V, HONDA CIVIC VIII Saloon (FD, FA) 1.8 EXS Flex, HONDA CIVIC IX (FK) 1.4 i-VTEC (FK1), HONDA CIVIC IX (FK) 1.8 i-VTEC (FK2), HONDA CIVIC IX (FK) 2.2 i-DTEC (FK3), HONDA Accord VII Saloon (CL, CN) 2.0, HONDA Accord VII Saloon (CL, CN) 2.4, HONDA Accord VII Tourer (CM, CN) 2.0, HONDA Accord VII Tourer (CM, CN) 2.4, HONDA Accord VII Saloon (CL, CN) 2.2 i-CTDi (CN1), HONDA Accord VII Tourer (CM, CN) 2.2 i-CTDi (CN2), (+ 39)

The steps may slightly vary depending on the car design.

Replacement: pollen filter – Honda Civic 8. AUTODOC recommends:

- Replace the cabin filter at least once every six months, in early spring and autumn seasons.
- Follow the terms, recommendations and requirements of the part operation provided by the manufacturer.
- If the air flow into the cabin has sharply reduced, replace the filter before a scheduled maintenance.
- All work should be done with the engine stopped.

**REPLACEMENT: POLLEN FILTER – HONDA CIVIC 8. TAKE THE FOLLOWING STEPS:**

**1** Open the car door.



**2** Remove the cover under the glove box.

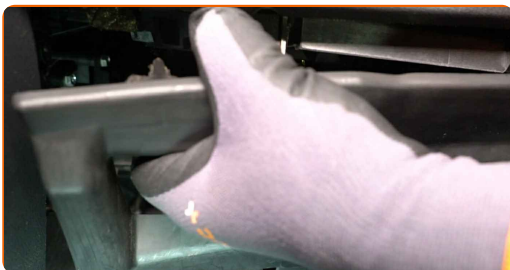

**3** Remove the cabin filter housing cover.



**4** Remove the cabin filter.



**AUTODOC recommends:**

- Do not attempt to clean and reuse the filter – this will reduce the quality of cabin air filtration.

**5** Install the new pollen filter.

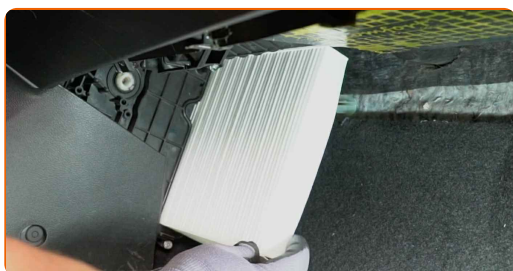

Replacement: pollen filter – Honda Civic 8. Professionals recommend:

- Follow the air flow direction arrow on the filter.
- Take care to only use quality filters.

6

Install the cabin filter housing cover.

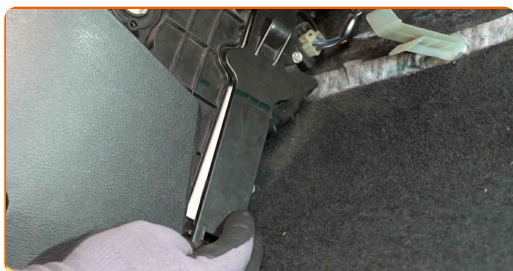

7

Install and secure the cover under the glove box.

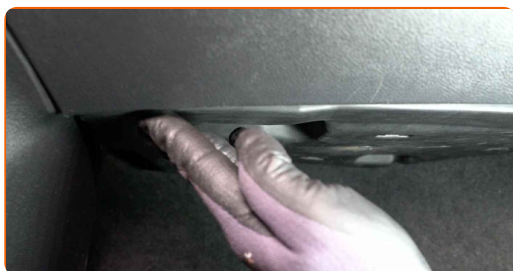

8

Close the car door.



9 Switch on the ignition.

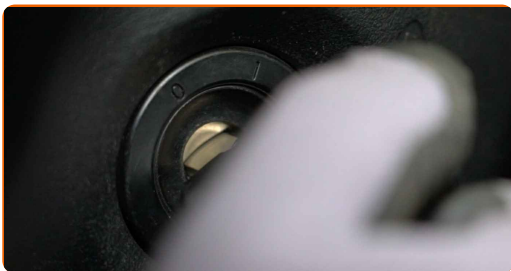

10 Switch on the air conditioning system.



Replacement: pollen filter – Honda Civic 8. Tip from AUTODOC experts:

- This is necessary in order to make sure that the component operates properly.

11 Switch off the ignition.

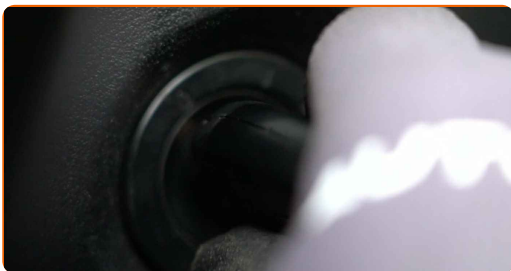

**WELL DONE!** 

[VIEW MORE TUTORIALS](#)

# AUTODOC – TOP QUALITY AND AFFORDABLE CAR PARTS ONLINE

**AUTODOC MOBILE APP: GREAT DEALS AND CONVENIENT SHOPPING**



**+ AUTODOC**

GET IT ON  **Google Play**

 **Download on the App Store**

**Download**

**A GREAT SELECTION OF SPARE PARTS FOR YOUR CAR**

**BUY SPARE PARTS FOR HONDA**

**POLLEN FILTER: A WIDE SELECTION**

**CHOOSE CAR PARTS FOR HONDA CIVIC 8**

**POLLEN FILTER FOR HONDA: BUY NOW**

**POLLEN FILTER FOR HONDA CIVIC 8: THE BEST DEALS & OFFERS**

### **DISCLAIMER:**

The document contains only general recommendations that may be useful for you when you perform repair or replacement work. AUTODOC shall not be liable for any loss, injury, damage of property occurring in the repair or replacement process due to incorrect use or misinterpretation of the provided information.

AUTODOC shall not be liable for any possible mistakes and uncertainties in this guide. The information provided is for information purposes only and cannot replace advice from specialists.

AUTODOC shall not be liable for incorrect or hazardous usage of equipment, tools and car parts. AUTODOC strongly recommends to be careful and observe the safety rules when performing repair or replacement works. Remember: usage of low quality auto parts does not guarantee you the appropriate level of road safety.

© Copyright 2023 – All the contents of this website, in particular texts, photographs and graphics, are protected by copyright. All rights, including reproduction, publication, editing and translation rights, are reserved by AUTODOC GmbH.