



How to change auxiliary
indicator on **Honda Civic**
8 – replacement guide

VIDEO TUTORIAL

** Important!**

This replacement procedure can be used for:

HONDA CIVIC VIII Hatchback (FN, FK) 1.4 (FK1), HONDA CIVIC VIII Hatchback (FN, FK) 2.2 CTDi (FK3), HONDA CIVIC VIII Hatchback (FN, FK) 2.0 R, HONDA CIVIC VIII Hatchback (FN, FK) 1.4 (FK1, FN4)

The steps may slightly vary depending on the car design.

REPLACEMENT: AUXILIARY INDICATOR – HONDA CIVIC
8. TOOLS YOU NEED:

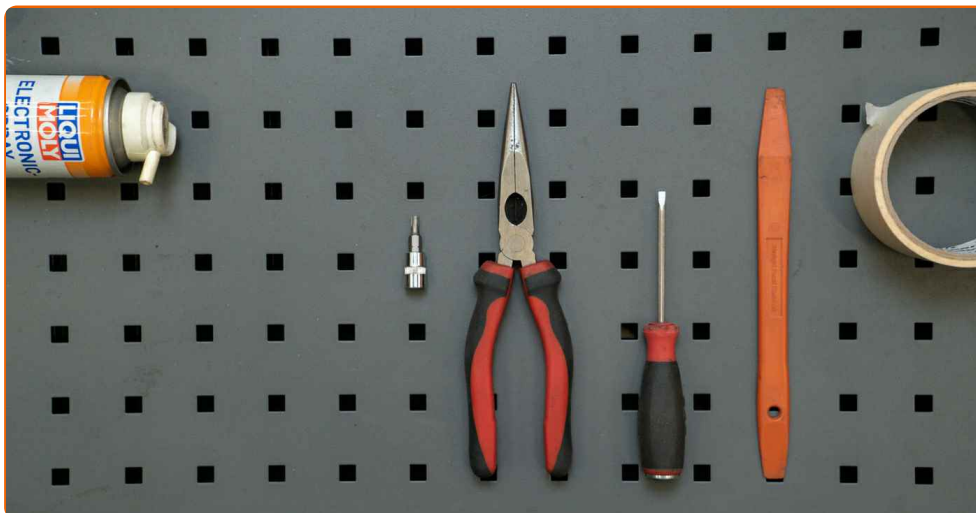

- Electronic spray
- Torx bit T20
- Long nose pliers
- Flat screwdriver
- Plastic trim tool
- Painter's tape

BUY TOOLS

Replacement: auxiliary indicator – Honda Civic 8. Tip from AUTODOC experts:

- Replace both turn signal repeater lights at the same time.
- The procedure for replacing the right and left turn signal repeater lights is the same.
- Please note: all work on the car – Honda Civic 8 – should be done with the engine switched off.

CARRY OUT REPLACEMENT IN THE FOLLOWING ORDER:

1 Switch on the ignition.

2 Turn the mirror glass all the way inward.



3 Switch off the ignition.

4 Use the masking tape to prevent plastic and painted parts of the car from being damaged.



5 Carefully release the mirror glass from its attachment. Use a plastic trim tool. Use a flat screwdriver.



6 Remove the mirror glass.

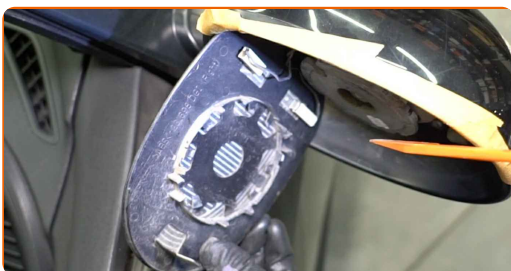

AUTODOC recommends:

- Replacement: auxiliary indicator – Honda Civic 8. Do not use excessive force when removing the part as this may damage it.

7 Detach the mirror heating connectors.

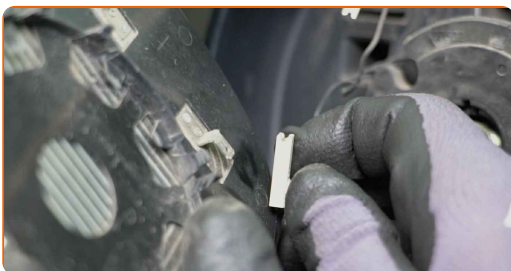

8 Unclip the mirror cover retainers. Use a plastic trim tool. Use long nose pliers.

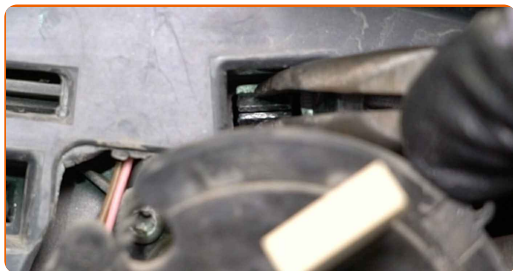

9 Remove the wing mirror cover.



10 Detach the connector of the turn signal repeater light.

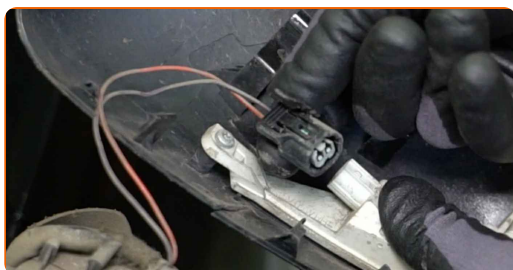

11 Unscrew the fasteners of the turn signal repeater light from the mirror cover. Use Torx T20.

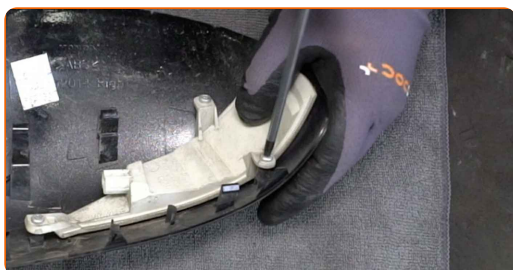

12 Remove the turn signal repeater light.



13

Install a new turn signal repeater light.

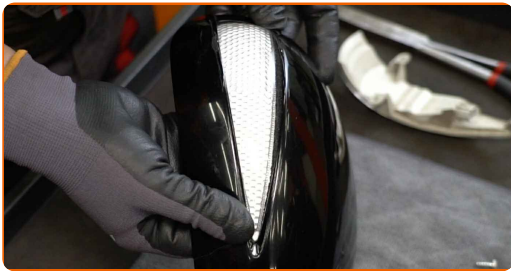

14

Screw in the fasteners connecting the turn signal repeater light to the mirror cover. Use Torx T20.



15

Treat the connector of the turn signal repeater light. Use dielectric grease.

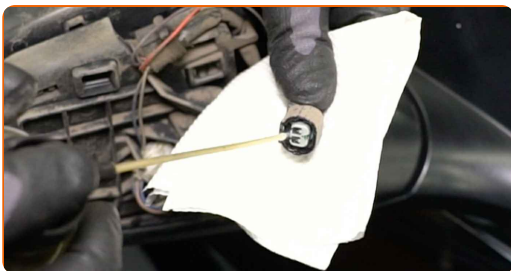

16

Attach the connector of the turn signal repeater light.

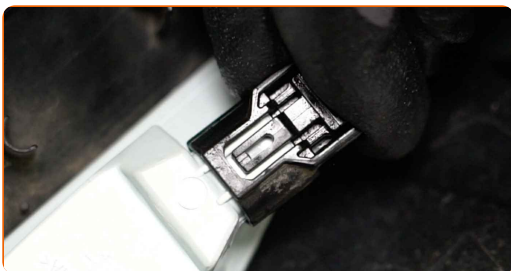

17

Install the wing mirror housing. Make sure you hear a click indicating that it is locked in place.

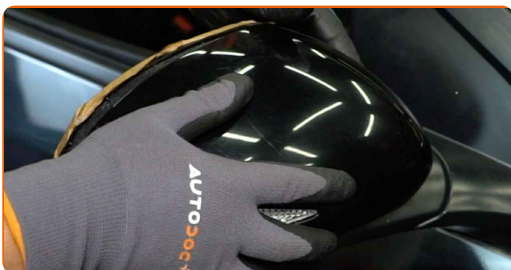

Replacement: auxiliary indicator – Honda Civic 8. AUTODOC experts recommend:

- When installing, do not use excessive force to avoid damage to the part.

18

Treat the mirror heating connectors. Use dielectric grease.

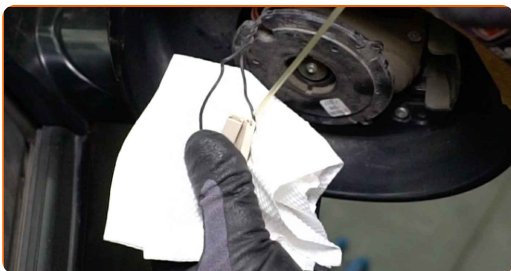

19

Attach the mirror heating connectors.



20

Fit the mirror glass into position. Make sure you hear a click indicating that it is locked in place.

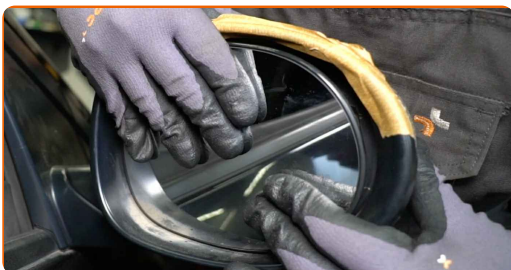

Replacement: auxiliary indicator – Honda Civic 8. Professionals recommend:

- Make sure the mirror glass is positioned correctly. It should be aligned with the locking tabs on the housing.
- When installing, do not use excessive force to avoid damage to the part.

21

Remove the masking tape.

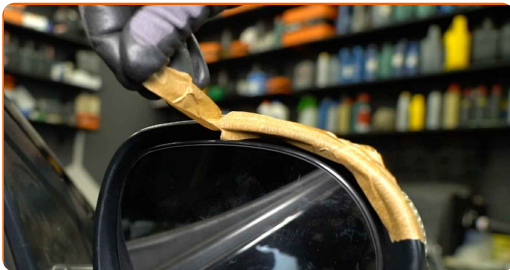

22

Switch on the ignition.

23

Adjust the mirror glass.



24

Check the operation of the turn signal repeater light.

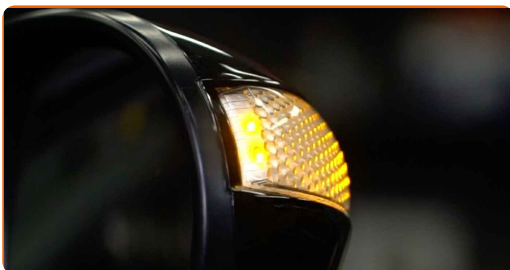

25

Switch off the ignition.

WELL DONE! 

VIEW MORE TUTORIALS

AUTODOC – TOP QUALITY AND AFFORDABLE CAR PARTS ONLINE

AUTODOC MOBILE APP: GREAT DEALS AND CONVENIENT SHOPPING



+ AUTODOC

GET IT ON  **Google Play**

 **Download on the App Store**

Download

A GREAT SELECTION OF SPARE PARTS FOR YOUR CAR

BUY SPARE PARTS FOR HONDA

AUXILIARY INDICATOR: A WIDE SELECTION

CHOOSE CAR PARTS FOR HONDA CIVIC 8

AUXILIARY INDICATOR FOR HONDA: BUY NOW

**AUXILIARY INDICATOR FOR HONDA CIVIC 8: THE BEST
DEALS & OFFERS**

DISCLAIMER:

The document contains only general recommendations that may be useful for you when you perform repair or replacement work. AUTODOC shall not be liable for any loss, injury, damage of property occurring in the repair or replacement process due to incorrect use or misinterpretation of the provided information.

AUTODOC shall not be liable for any possible mistakes and uncertainties in this guide. The information provided is for information purposes only and cannot replace advice from specialists.

AUTODOC shall not be liable for incorrect or hazardous usage of equipment, tools and car parts. AUTODOC strongly recommends to be careful and observe the safety rules when performing repair or replacement works. Remember: usage of low quality auto parts does not guarantee you the appropriate level of road safety.

© Copyright 2023 – All the contents of this website, in particular texts, photographs and graphics, are protected by copyright. All rights, including reproduction, publication, editing and translation rights, are reserved by AUTODOC SE.