

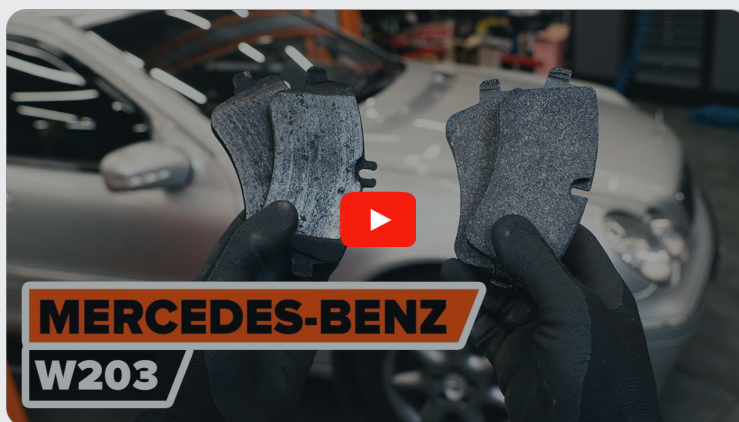

How to change front
brake pads on **Mercedes**
W203 – replacement
guide

VIDEO TUTORIAL



i Important!

This replacement procedure can be used for:

MERCEDES-BENZ C-Class Saloon (W203) C 320 (203.064), MERCEDES-BENZ C-Class Saloon (W203) C 270 CDI (203.016), MERCEDES-BENZ C-Class Coupe (CL203) C 230 Kompressor (203.747), MERCEDES-BENZ C-Class T-modell (S203) C 320 (203.264), MERCEDES-BENZ C-Class T-modell (S203) C 270 CDI (203.216), MERCEDES-BENZ C-Class T-modell (S203) C 240 (203.261), MERCEDES-BENZ CLK Coupe (C209) 320 3.2 (209.365), MERCEDES-BENZ CLK Coupe (C209) 240 2.6 (209.361), MERCEDES-BENZ CLK Coupe (C209) 270 CDI 2.7 (209.316), MERCEDES-BENZ C-Class Coupe (CL203) C 230 Kompressor (203.740), MERCEDES-BENZ C-Class Saloon (W203) C 240 4-matic (203.081), MERCEDES-BENZ C-Class Saloon (W203) C 320 4-matic (203.084), MERCEDES-BENZ C-Class T-modell (S203) C 240 4-matic (203.281), MERCEDES-BENZ C-Class T-modell (S203) C 320 4-matic (203.284), MERCEDES-BENZ C-Class Coupe (CL203) C 320 (203.764), (+ 22)

The steps may slightly vary depending on the car design.

REPLACEMENT: BRAKE PADS – MERCEDES W203. LIST OF THE TOOLS YOU'LL NEED:



- Wire brush
- Nylon cleaning brush
- WD-40 spray
- Brake cleaner
- Anti-squeal paste
- Copper grease
- Torque wrench
- Drive socket # 12
- Wheel impact socket #17
- Ratchet wrench
- Brake caliper wind back tool
- Crow bar
- Round-nose pliers
- Wheel chock

[BUY TOOLS](#)

Replacement: brake pads – Mercedes W203. AUTODOC experts recommend:

- Perform the replacement of brake pads in complete set for each axis. This provides effective braking.
- The replacement procedure is identical for all brake pads on the same axle.
- Warning! Shut down the engine before starting any work – Mercedes W203.

CARRY OUT REPLACEMENT IN THE FOLLOWING ORDER:

1

Open the bonnet. Unscrew the brake fluid reservoir cap.

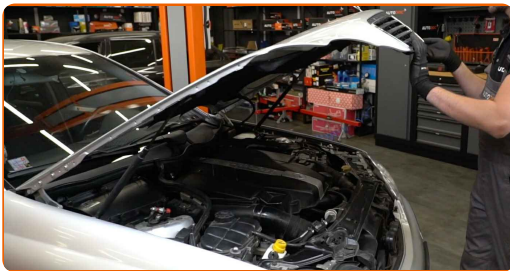

2

Secure the wheels with chocks.



3

Loosen the wheel mounting bolts. Use wheel impact socket #17.



4

Raise the front of the car and secure on supports.



5

Unscrew the wheel bolts.



Replacement: brake pads – Mercedes W203. Tip from AUTODOC:

- To avoid injury, hold up the wheel when unscrewing the bolts.

6

Remove the wheel.



7

Detach the connector of the brake pad wear sensor. Use round-nose pliers.



8

Clean the brake caliper fasteners. Use a wire brush. Use WD-40 spray.

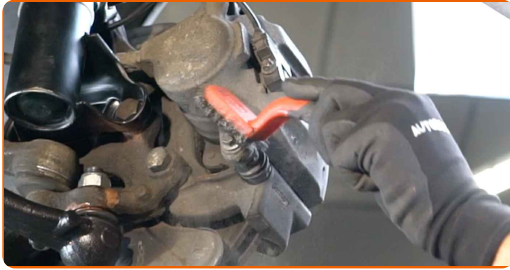

9

Unscrew the brake caliper fastening. Use a drive socket #12. Use a ratchet wrench.



10

Spread the brake pads. Use a crowbar.



11

Remove the brake caliper.



Replacement: brake pads – Mercedes W203. Professionals recommend:

- Tie the caliper to the suspension or to the body with a wire without disconnecting from the brake hose to prevent depressurization of the brake system.
- Make sure that the brake caliper is not hanging on the brake hose.
- Don't press the brake pedal after the brake caliper has been removed. As a result, the piston can fall out from the brake cylinder, and brake fluid leakage and depressurization of the system may occur.
- Check the brake caliper bracket, brake caliper guide pins and boots. Clean them. Replace, if necessary.

12

Remove the brake pads.

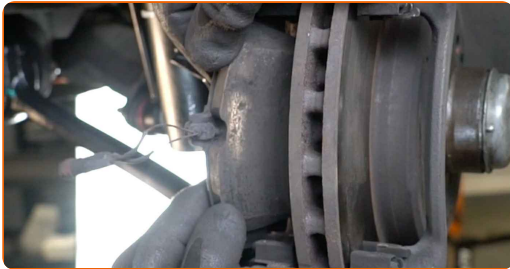

AUTODOC recommends:

- Measure the brake disc thickness. Upon reaching the wear limit the part must be replaced.

- 13 Remove the retaining springs of the brake pads. Use a crowbar.



- 14 Clean the brake caliper bracket from dirt and dust. Use a wire brush. Use a brake cleaner.



AUTODOC recommends:

- Replacement: brake pads – Mercedes W203. After applying the spray, wait a few minutes.

- 15 Install the retaining springs of the brake pads.



- 16 Treat the brake pads in the area where their surface comes into contact with the brake caliper bracket. Use anti-squeal paste.



Replacement: brake pads – Mercedes W203. Tip:

- Make sure the disc surface is clean before installing the pads.

17

Install new brake pads.

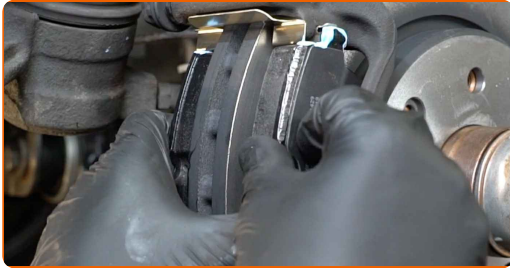

AUTODOC recommends:

- Make sure the pads are installed with linings facing the disc.

18

Treat the brake caliper piston. Use a nylon cleaning brush. Use a brake cleaner.

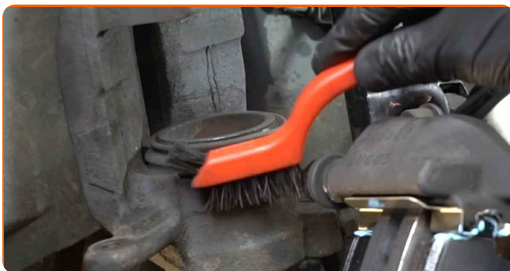

Replacement: brake pads – Mercedes W203. AUTODOC recommends:

- After applying the spray, wait a few minutes.

19

Press in the brake caliper piston. Use brake caliper wind back tool.



20

Install the brake caliper and fix it. Use a drive socket #12. Use a torque wrench. Tighten it to 25 Nm torque.

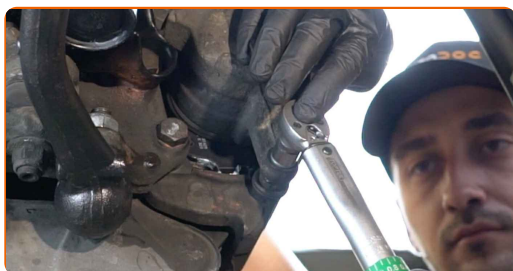

21

Attach the connector of the brake pad wear sensor.

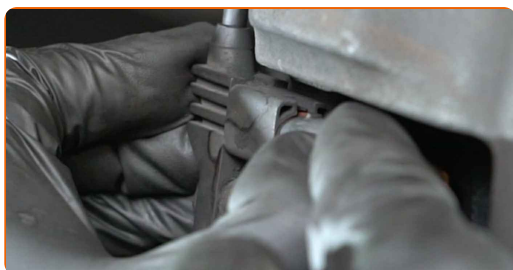

22

Treat the surface where the brake disc contacts the wheel rim. Use copper grease.



23

Clean the brake disk surface. Use a brake cleaner.



AUTODOC recommends:

- Replacement: brake pads – Mercedes W203. After applying the spray, wait a few minutes.

24

Install the wheel.



Replacement: brake pads – Mercedes W203. AUTODOC experts recommend:

- To avoid injury, hold up the wheel when screwing in the fastening bolts.

25

Screw in the wheel bolts. Use wheel impact socket #17.



26

Lower the car and working in a cross order, tighten the wheel bolts. Use wheel impact socket #17. Use a torque wrench. Tighten it to 110 Nm torque.



27

Remove the jacks and chocks.



Replacement: brake pads – Mercedes W203. Tip from AUTODOC experts:

- Check the brake fluid level in the expansion tank and refill if necessary.

28

Tighten the brake fluid reservoir cap. Close the hood.

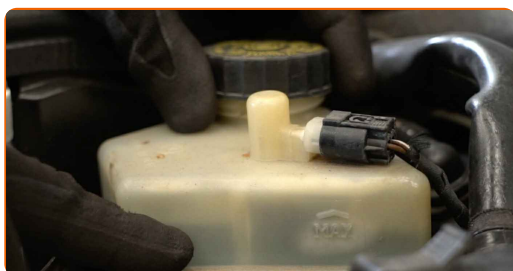

AUTODOC recommends:

- Mercedes W203 – Press the brake pedal several times with the engine shut down until you feel the resistance built up.
- Slow down smoothly for first 150-200 km after the brake pads replacement. Avoid unnecessary and sharp braking to a stop.

WELL DONE! 

[VIEW MORE TUTORIALS](#)

AUTODOC – TOP QUALITY AND AFFORDABLE CAR PARTS ONLINE

AUTODOC MOBILE APP: GREAT DEALS AND CONVENIENT SHOPPING



+ AUTODOC

GET IT ON
Google Play

Download on the
App Store

Download

A GREAT SELECTION OF SPARE PARTS FOR YOUR CAR

BUY SPARE PARTS FOR MERCEDES

BRAKE PADS: A WIDE SELECTION

CHOOSE CAR PARTS FOR MERCEDES W203

BRAKE PADS FOR MERCEDES: BUY NOW

BRAKE PADS FOR MERCEDES W203: THE BEST DEALS & OFFERS

DISCLAIMER:

The document contains only general recommendations that may be useful for you when you perform repair or replacement work. AUTODOC shall not be liable for any loss, injury, damage of property occurring in the repair or replacement process due to incorrect use or misinterpretation of the provided information.

AUTODOC shall not be liable for any possible mistakes and uncertainties in this guide. The information provided is for information purposes only and cannot replace advice from specialists.

AUTODOC shall not be liable for incorrect or hazardous usage of equipment, tools and car parts. AUTODOC strongly recommends to be careful and observe the safety rules when performing repair or replacement works. Remember: usage of low quality auto parts does not guarantee you the appropriate level of road safety.

© Copyright 2022 – All the contents of this website, in particular texts, photographs and graphics, are protected by copyright. All rights, including reproduction, publication, editing and translation rights, are reserved by AUTODOC GmbH.