



How to change pollen
filter on **BMW E82** –
replacement guide

VIDEO TUTORIAL



Important!

This replacement procedure can be used for:

BMW 3 Touring (E91) 325i 3.0, BMW 3 Touring (E91) 318d 2.0, BMW 3 Saloon (E90) 318d 2.0, BMW 1 Coupe (E82) M, BMW X1 (E84) xDrive 28 i, BMW 3 Touring (E91) 318i 2.0, BMW 3 Touring (E91) 316d 2.0, BMW 3 Saloon (E90) 320d xDrive 2.0, BMW X1 (E84) sDrive 20 i, BMW X1 (E84) xDrive 20 i, BMW 1 Coupe (E82) 118d 2.0, BMW 3 Coupe (E92) 318i 2.0, BMW 3 Convertible (E93) 318i 2.0, BMW 3 Convertible (E93) 325d 3.0, BMW 1 Hatchback (E81) 116i 1.6, (+ 132)

The steps may slightly vary depending on the car design.

REPLACEMENT: POLLEN FILTER – BMW E82. TOOLS
YOU MIGHT NEED:



- Drive socket # 8
- Ratchet wrench
- Fender cover

BUY TOOLS

Replacement: pollen filter – BMW E82. Professionals recommend:

- Replace the cabin filter at least once every six months, in early spring and autumn seasons.
- Follow the terms, recommendations and requirements of the part operation provided by the manufacturer.
- If the air flow into the cabin has sharply reduced, replace the filter before a scheduled maintenance.
- Please note: all work on the car – BMW E82 – should be done with the engine switched off.

CARRY OUT REPLACEMENT IN THE FOLLOWING ORDER:

1 Open the bonnet.

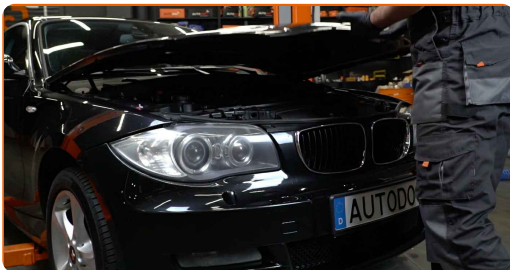

2 Use a fender protection cover to prevent damaging paintwork and plastic parts of the car.



3 Unscrew the fasteners of the cabin filter housing cover. Use a drive socket #8. Use a ratchet wrench.

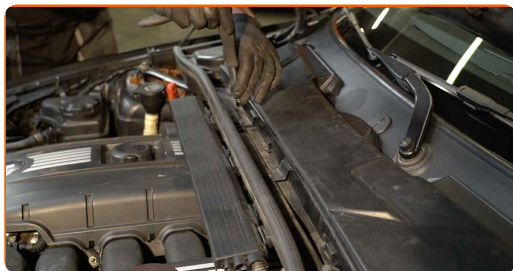

4 Remove the cabin filter housing cover.

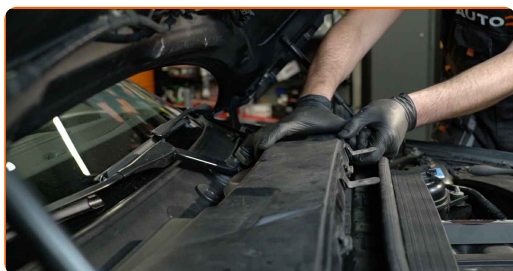

AUTODOC recommends:

- Replacement: pollen filter – BMW E82. Do not use excessive force when removing the part as this may damage it.

5 Release the cabin filter cover clips.

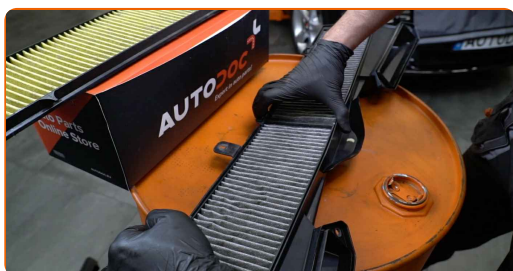

6 Remove the filter element from the filter housing.

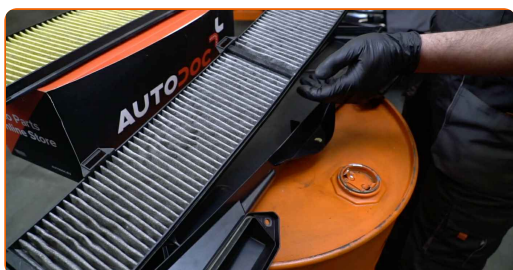

Replacement: pollen filter – BMW E82. Professionals recommend:

- Do not attempt to clean and reuse the filter - it will affect the quality of air cleaning inside the car.

7

Clean the cabin filter housing and cover.

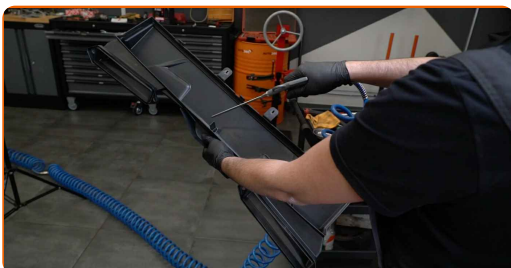

Replacement: pollen filter – BMW E82. Tip from AUTODOC:

- Remove any debris from the cabin filter housing carefully to prevent contamination of the ventilation duct.

8

Insert a new filter element into the filter housing. Make sure that the filter edge fits tight to the housing. Make sure you hear a click indicating that it is locked in place.



AUTODOC recommends:

- Replacement: pollen filter – BMW E82. Be sure to position the filtering element correctly. Avoid misalignment.
- Follow the air flow direction arrow on the filter.
- BMW E82 – It's important to only use high-quality filters.

9

Clean the mounting seat of the cabin filter housing.

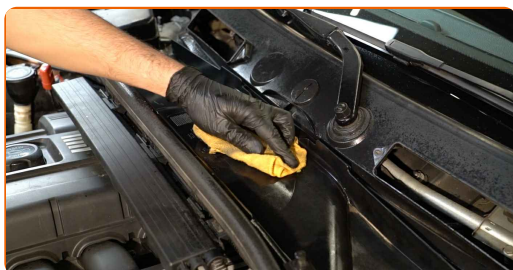

10

Reinstall the cabin filter housing cover. Make sure you hear a click indicating that it is locked in place.

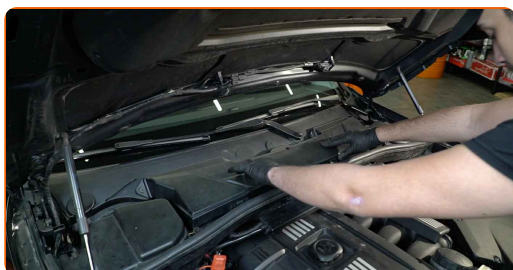

AUTODOC recommends:

- Replacement: pollen filter – BMW E82. Do not use excessive force during installation. This may damage the fasteners.

11 Screw in the fasteners of the cabin filter housing cover. Use a drive socket #8. Use a ratchet wrench.

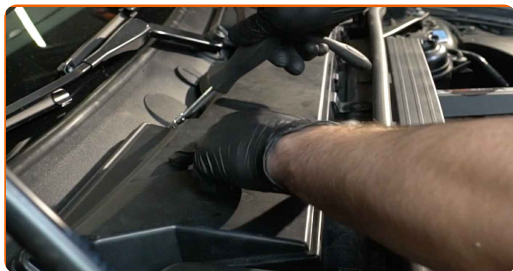

12 Remove the fender protection cover.



13 Close the hood.

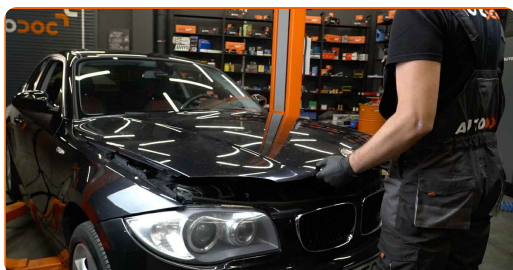

14 Switch on the ignition.

15 Switch on the air conditioning system. This is necessary in order to make sure that the component operates properly.



16

Switch off the ignition.

WELL DONE! 

VIEW MORE TUTORIALS

AUTODOC – TOP QUALITY AND AFFORDABLE CAR PARTS ONLINE

AUTODOC MOBILE APP: GREAT DEALS AND CONVENIENT SHOPPING



+ AUTODOC

GET IT ON  **Google Play**

 **Download on the App Store**

Download

A GREAT SELECTION OF SPARE PARTS FOR YOUR CAR

BUY SPARE PARTS FOR BMW

POLLEN FILTER: A WIDE SELECTION

CHOOSE CAR PARTS FOR BMW E82

POLLEN FILTER FOR BMW: BUY NOW

POLLEN FILTER FOR BMW E82: THE BEST DEALS & OFFERS

DISCLAIMER:

The document contains only general recommendations that may be useful for you when you perform repair or replacement work. AUTODOC shall not be liable for any loss, injury, damage of property occurring in the repair or replacement process due to incorrect use or misinterpretation of the provided information.

AUTODOC shall not be liable for any possible mistakes and uncertainties in this guide. The information provided is for information purposes only and cannot replace advice from specialists.

AUTODOC shall not be liable for incorrect or hazardous usage of equipment, tools and car parts. AUTODOC strongly recommends to be careful and observe the safety rules when performing repair or replacement works. Remember: usage of low quality auto parts does not guarantee you the appropriate level of road safety.

© Copyright 2023 – All the contents of this website, in particular texts, photographs and graphics, are protected by copyright. All rights, including reproduction, publication, editing and translation rights, are reserved by AUTODOC SE.