



How to change pollen
filter on **ALFA ROMEO**
Brera (939_) –
replacement guide

SIMILAR VIDEO TUTORIAL



This video shows the replacement procedure of a similar car part on another vehicle

Important!

This replacement procedure can be used for:

ALFA ROMEO Brera (939_) 2.0 JTDM, ALFA ROMEO Brera (939_) 2.2 JTS (939.DXB11), ALFA ROMEO Brera (939_) 3.2 JTS Q4 (939.DXG22), ALFA ROMEO Brera (939_) 2.4 JTDM 20V, ALFA ROMEO Brera (939_) 3.2 JTS, ALFA ROMEO Brera (939_) 1.8 TBi

The steps may slightly vary depending on the car design.

This tutorial was created based on the replacement procedure for a similar car part on: ALFA ROMEO 159 Sportwagon (939) 2.2 JTS

REPLACEMENT: POLLEN FILTER – ALFA ROMEO BRERA (939_). TOOLS YOU NEED:



- Drive socket # 5.5
- Flat Screwdriver
- Phillips screwdriver

Buy tools

Replacement: pollen filter – ALFA ROMEO Brera (939_). Tip from AUTODOC experts:

- Replace the cabin filter at least once every six months, in early spring and autumn seasons.
- Follow the terms, recommendations and requirements of the part operation provided by the manufacturer.
- If the air flow into the cabin has sharply reduced, replace the filter before a scheduled maintenance.
- Please note: all work on the car – ALFA ROMEO Brera (939_) – should be done with the engine switched off.

CARRY OUT REPLACEMENT IN THE FOLLOWING ORDER:

1 Move the passenger seat fully backwards.

2 Open the glove box.



3 Undo the glove box lining screw and remove the lining. Use a flat screwdriver. Use a Phillips screwdriver.

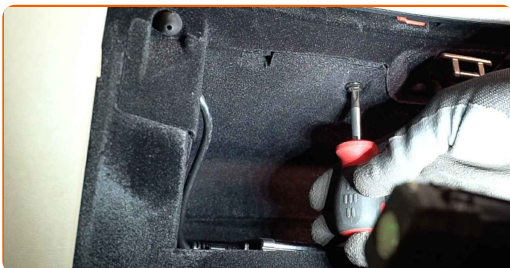

4

Unscrew the fasteners of the cabin filter housing cover. Use a drive socket #5.5.



5

Remove the cabin filter.



Replacement: pollen filter – ALFA ROMEO Brera (939_). Tip:

- Do not attempt to clean and reuse the filter - it will affect the quality of air cleaning inside the car.

6

Install the cabin filter to its mounting seat.



Replacement: pollen filter – ALFA ROMEO Brera (939_). AUTODOC experts recommend:

- Follow the air flow direction arrow on the filter.
- Replacement: pollen filter – ALFA ROMEO Brera (939_). Be sure to position the filtering element correctly. Avoid misalignment.
- Take care to only use quality filters.

7

Screw in the fasteners of the cabin filter housing cover. Use a drive socket #5.5.



8

Install the glove box lining and screw in its fasteners. Use a Phillips screwdriver.



9

Close the glove box.

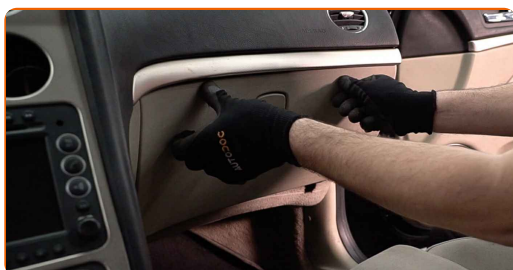

10

Return the passenger seat to its initial position.



11

Switch on the ignition.

12

Switch on the air conditioning system. This is necessary in order to make sure that the component operates properly.

13

Switch off the ignition.

WELL DONE! 

[VIEW MORE TUTORIALS](#)

AUTODOC – TOP QUALITY AND AFFORDABLE CAR PARTS ONLINE

AUTODOC MOBILE APP: GREAT DEALS AND CONVENIENT SHOPPING



+ AUTODOC

GET IT ON
Google Play

 Download on the
App Store

Download

A GREAT SELECTION OF SPARE PARTS FOR YOUR CAR

POLLEN FILTER: A WIDE SELECTION

DISCLAIMER:

The document contains only general recommendations that may be useful for you when you perform repair or replacement work. AUTODOC shall not be liable for any loss, injury, damage of property occurring in the repair or replacement process due to incorrect use or misinterpretation of the provided information.

AUTODOC shall not be liable for any possible mistakes and uncertainties in this guide. The information provided is for information purposes only and cannot replace advice from specialists.

AUTODOC shall not be liable for incorrect or hazardous usage of equipment, tools and car parts. AUTODOC strongly recommends to be careful and observe the safety rules when performing repair or replacement works. Remember: usage of low quality auto parts does not guarantee you the appropriate level of road safety.

© Copyright 2023 – All the contents of this website, in particular texts, photographs and graphics, are protected by copyright. All rights, including reproduction, publication, editing and translation rights, are reserved by AUTODOC SE.