



How to change pollen
filter on **ALFA ROMEO**
156 Saloon (932) –
replacement guide

SIMILAR VIDEO TUTORIAL



This video shows the replacement procedure of a similar car part on another vehicle

ⓘ Important!

This replacement procedure can be used for:

ALFA ROMEO 156 Saloon (932) 1.6 16V T.SPARK, ALFA ROMEO 156 Saloon (932) 1.8 16V T.SPARK, ALFA ROMEO 156 Saloon (932) 2.0 16V T.SPARK, ALFA ROMEO 156 Saloon (932) 2.5 V6 24V, ALFA ROMEO 156 Saloon (932) 1.9 JTD, ALFA ROMEO 156 Saloon (932) 3.2 GTA, ALFA ROMEO 156 Saloon (932) 2.0 JTS, ALFA ROMEO 156 Saloon (932) 2.4 JTD, ALFA ROMEO 156 Saloon (932) 1.9 JTD 16V, ALFA ROMEO 156 Saloon (932) 1.9 JTD (932.AXN00, 932.BXE00)

The steps may slightly vary depending on the car design.

This tutorial was created based on the replacement procedure for a similar car part on: ALFA ROMEO 147 (937) 1.6 16V T.SPARK

REPLACEMENT: POLLEN FILTER – ALFA ROMEO 156 SALOON (932). TOOLS YOU NEED:



- Drive socket # 5.5
- Drive socket # 8
- Ratchet wrench
- Fender cover

Buy tools

Replacement: pollen filter – ALFA ROMEO 156 Saloon (932). AUTODOC experts recommend:

- Replace the cabin filter at least once every six months, in early spring and autumn seasons.
- Follow the terms, recommendations and requirements of the part operation provided by the manufacturer.
- If the air flow into the cabin has sharply reduced, replace the filter before a scheduled maintenance.
- Please note: all work on the car – ALFA ROMEO 156 Saloon (932) – should be done with the engine switched off.

CARRY OUT REPLACEMENT IN THE FOLLOWING ORDER:

- 1** Move the passenger seat fully backwards.



- 2** Spread a cloth under the cabin filter cover to protect the interior upholstery from getting dirty.

- 3** Unscrew the fasteners of the passenger side kick panel. Use a drive socket #8. Use a ratchet wrench.



4 Remove the cover under the glove box.



5 Unscrew the fasteners of the cabin filter housing cover. Use a drive socket #5.5. Use a ratchet wrench.

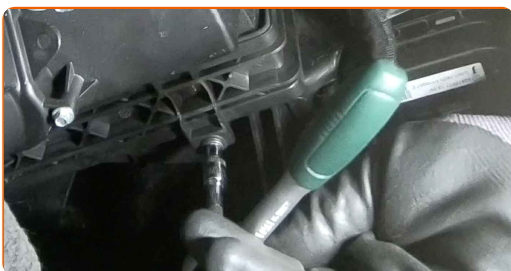

6 Remove the cabin filter cover.

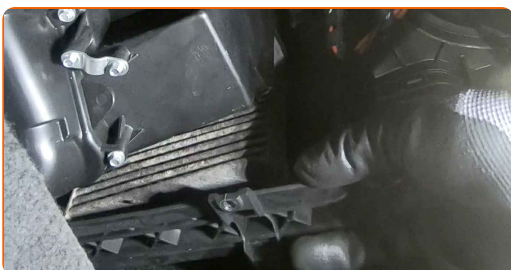

7 Remove the cabin filter.

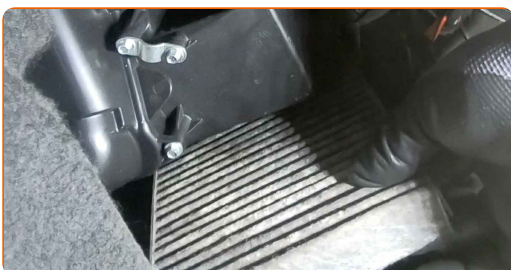

Replacement: pollen filter – ALFA ROMEO 156 Saloon (932). Tip from AUTODOC:

- Do not attempt to clean and reuse the filter - it will affect the quality of air cleaning inside the car.

8 Install the cabin filter to its mounting seat.

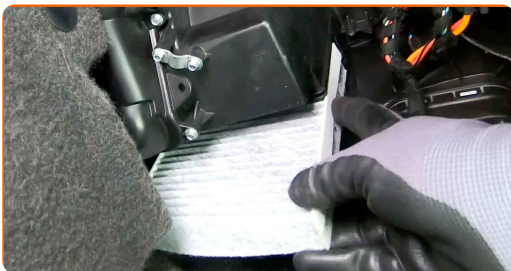

Replacement: pollen filter – ALFA ROMEO 156 Saloon (932). AUTODOC experts recommend:

- Follow the air flow direction arrow on the filter.
- Check out the correct location of the filter element. Do not skew.
- Attention! Use quality filters – ALFA ROMEO 156 Saloon (932).

9 Install the filter cover.



10 Screw in the fasteners of the cabin filter housing cover. Use a drive socket #5.5. Use a ratchet wrench.

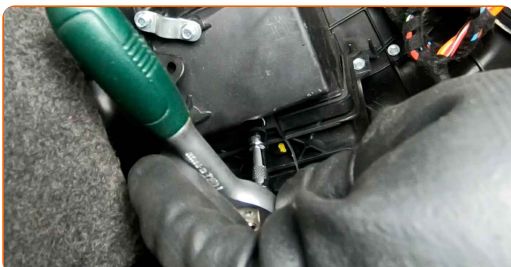

11 Install and secure the cover under the glove box.

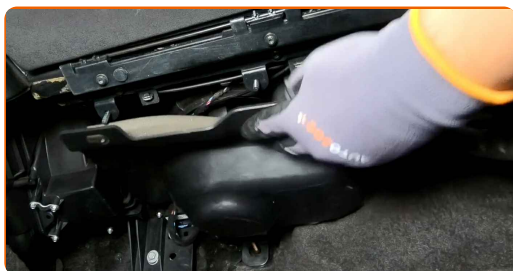

12 Screw in the fasteners of the passenger side kick panel. Use a drive socket #8. Use a ratchet wrench.

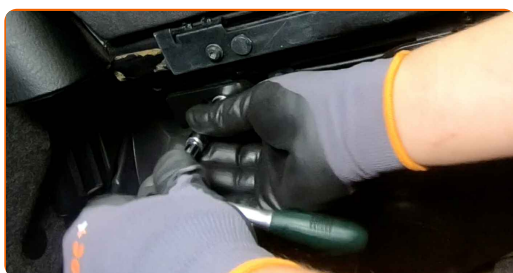

13 Remove the cloth.

14 Return the passenger seat to its initial position.

15 Switch on the ignition.

16 Switch on the air conditioning system. This is necessary in order to make sure that the component operates properly.

17 Switch off the ignition.

WELL DONE! 

VIEW MORE TUTORIALS

AUTODOC – TOP QUALITY AND AFFORDABLE CAR PARTS ONLINE

AUTODOC MOBILE APP: GREAT DEALS AND CONVENIENT SHOPPING



+ AUTODOC

GET IT ON
 **Google Play**

 **Download on the App Store**

Download

A GREAT SELECTION OF SPARE PARTS FOR YOUR CAR

POLLEN FILTER: A WIDE SELECTION

DISCLAIMER:

The document contains only general recommendations that may be useful for you when you perform repair or replacement work. AUTODOC shall not be liable for any loss, injury, damage of property occurring in the repair or replacement process due to incorrect use or misinterpretation of the provided information.

AUTODOC shall not be liable for any possible mistakes and uncertainties in this guide. The information provided is for information purposes only and cannot replace advice from specialists.

AUTODOC shall not be liable for incorrect or hazardous usage of equipment, tools and car parts. AUTODOC strongly recommends to be careful and observe the safety rules when performing repair or replacement works. Remember: usage of low quality auto parts does not guarantee you the appropriate level of road safety.

© Copyright 2023 – All the contents of this website, in particular texts, photographs and graphics, are protected by copyright. All rights, including reproduction, publication, editing and translation rights, are reserved by AUTODOC SE.