



How to change tailgate
struts on **Mercedes W168**
– replacement guide

VIDEO TUTORIAL



i Important!

This replacement procedure can be used for:

MERCEDES-BENZ A-Class (W168) A 140 (168.031, 168.131), MERCEDES-BENZ A-Class (W168) A 160 (168.033, 168.133), MERCEDES-BENZ A-Class (W168) A 160 CDI (168.007), MERCEDES-BENZ A-Class (W168) A 170 CDI (168.008), MERCEDES-BENZ A-Class (W168) A 190 (168.032, 168.132), MERCEDES-BENZ A-Class (W168) A 160 CDI (168.006), MERCEDES-BENZ A-Class (W168) A 170 CDI (168.009, 168.109), MERCEDES-BENZ A-Class (W168) A 210 (168.035, 168.135)

The steps may slightly vary depending on the car design.

REPLACEMENT: TAILGATE STRUTS – MERCEDES W168. TOOLS YOU NEED:

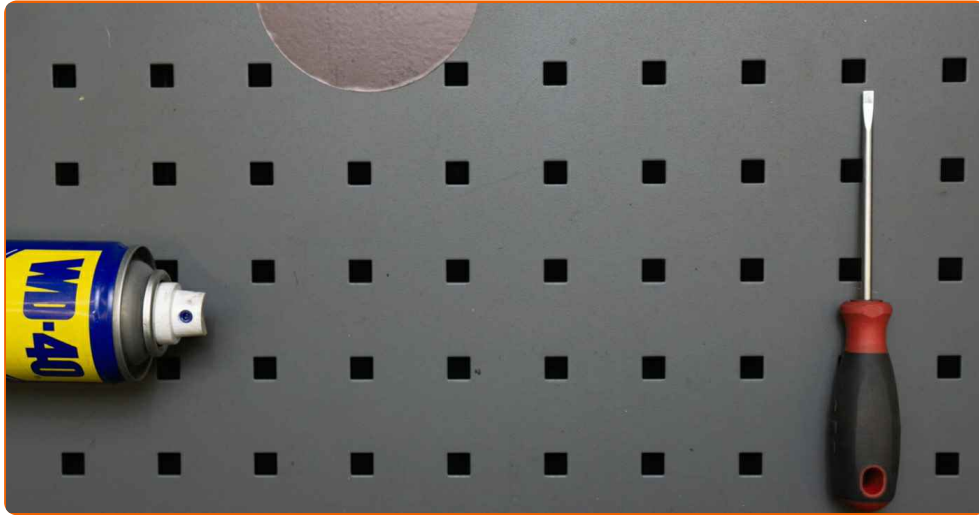

- WD-40 spray
- Flat Screwdriver
- Hydraulic transmission jack

BUY TOOLS

Replacement: tailgate struts – Mercedes W168. AUTODOC experts recommend:

- Right and left gas struts of the boot lid should be replaced simultaneously.
- The replacement procedure is identical for the right and left gas struts of the boot lid.
- Please note: all work on the car – Mercedes W168 – should be done with the engine switched off.

CARRY OUT REPLACEMENT IN THE FOLLOWING ORDER:

1

Open the boot lid.

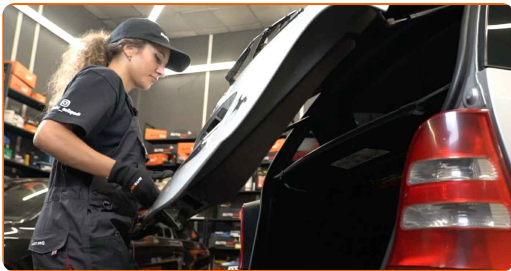

2

Support the boot lid. Use a hydraulic transmission jack.



3

Release the circlip connecting the gas strut to the boot lid. Use a flat screwdriver.

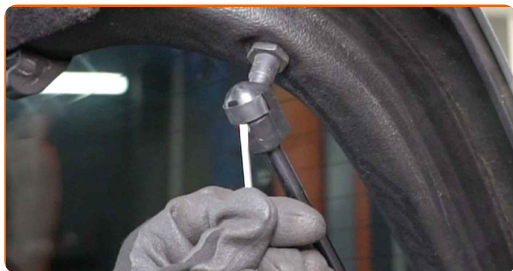

4

Release the circlip connecting the gas strut to the car body. Use a flat screwdriver.

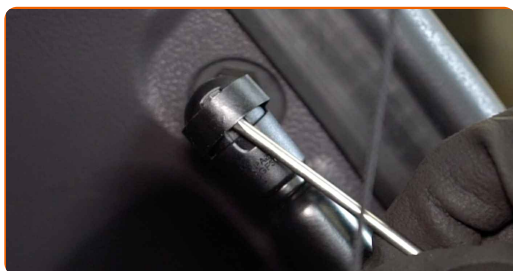

Replacement: tailgate struts – Mercedes W168. Tip from AUTODOC experts:

- To avoid any injuries, be sure to hold the boot lid while demounting the gas struts.

5

Remove the boot lid gas strut.



6

Release the circlip connecting the gas strut to the boot lid. Use a flat screwdriver.

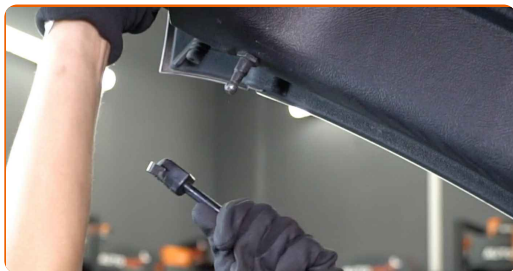

7

Release the circlip connecting the gas strut to the car body. Use a flat screwdriver.



Replacement: tailgate struts – Mercedes W168. AUTODOC experts recommend:

- To avoid any injuries, be sure to hold the boot lid while demounting the gas struts.

8

Remove the boot lid gas strut.

9

Clean the mounting seats of the boot strut. Use WD-40 spray.

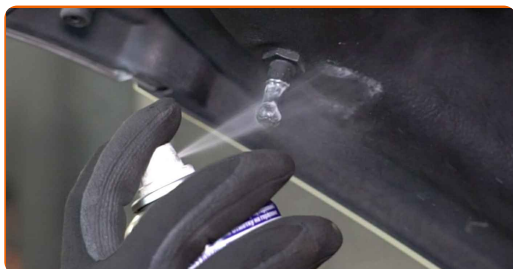

10 Install the new boot lid gas strut.



Replacement: tailgate struts – Mercedes W168. Professionals recommend:

- To avoid any injuries, be sure to hold the boot lid while installing the gas strut.

11 Snap on the circlip connecting the gas strut to the car body.



12 Snap on the circlip connecting the gas strut to the boot lid.



13 Install the new boot lid gas strut.

Replacement: tailgate struts – Mercedes W168. AUTODOC recommends:

- To avoid any injuries, be sure to hold the boot lid while installing the gas strut.

14

Snap on the circlip connecting the gas strut to the car body.



15

Snap on the circlip connecting the gas strut to the boot lid.



16

Remove the hydraulic transmission jack.



AUTODOC recommends:

- Replacement: tailgate struts – Mercedes W168. Lower the transmission jack smoothly, without jerks, to avoid damaging components and mechanisms.

17

Check the working condition of the boot lid gas springs after they are installed.

**18**

Close the lid of the luggage compartment.



WELL DONE! 

VIEW MORE TUTORIALS

AUTODOC – TOP QUALITY AND AFFORDABLE CAR PARTS ONLINE

AUTODOC MOBILE APP: GREAT DEALS AND CONVENIENT SHOPPING



+ AUTODOC

GET IT ON
Google Play

Download on the
App Store

Download

A GREAT SELECTION OF SPARE PARTS FOR YOUR CAR

BUY SPARE PARTS FOR MERCEDES

TAILGATE STRUTS: A WIDE SELECTION

CHOOSE CAR PARTS FOR MERCEDES W168

TAILGATE STRUTS FOR MERCEDES: BUY NOW

**TAILGATE STRUTS FOR MERCEDES W168: THE BEST DEALS
& OFFERS**

DISCLAIMER:

The document contains only general recommendations that may be useful for you when you perform repair or replacement work. AUTODOC shall not be liable for any loss, injury, damage of property occurring in the repair or replacement process due to incorrect use or misinterpretation of the provided information.

AUTODOC shall not be liable for any possible mistakes and uncertainties in this guide. The information provided is for information purposes only and cannot replace advice from specialists.

AUTODOC shall not be liable for incorrect or hazardous usage of equipment, tools and car parts. AUTODOC strongly recommends to be careful and observe the safety rules when performing repair or replacement works. Remember: usage of low quality auto parts does not guarantee you the appropriate level of road safety.

© Copyright 2023 – All the contents of this website, in particular texts, photographs and graphics, are protected by copyright. All rights, including reproduction, publication, editing and translation rights, are reserved by AUTODOC SE.